



# FULL DC INVERTER SYSTEMS

## SERVICE MANUAL

INDOOR CASSETTE UNITS SDV5-56-140CA

COMMERCIAL AIR CONDITIONERS SDV5

Original instructions

**IMPORTANT NOTE:**

Read this manual carefully before installing or operating your new air conditioning unit. Make sure to save this manual for future reference.

<b>1</b>	<b>Specifications .....</b>	<b>4</b>
<b>2</b>	<b>Dimensions.....</b>	<b>8</b>
<b>3</b>	<b>Unit Placement .....</b>	<b>9</b>
<b>4</b>	<b>Piping Diagram .....</b>	<b>11</b>
<b>5</b>	<b>Wiring Diagram.....</b>	<b>12</b>
<b>6</b>	<b>Capacity Tables .....</b>	<b>15</b>
<b>7</b>	<b>Electrical Characteristics .....</b>	<b>25</b>
<b>8</b>	<b>Sound Levels.....</b>	<b>26</b>

Table 1.2: SDV5-56-80CA specifications

Model			SDV5-56CA	SDV5-71CA	SDV5-80CA
Power supply			1 phase, 220-240V, 50Hz		
Cooling <sup>1</sup>	Capacity	kW	5.6	7.1	8.0
		kBtu/h	19.1	24.2	27.3
	Power input	W	31	46	48
Heating <sup>2</sup>	Capacity	kW	6.3	8.0	9.0
		kBtu/h	21.5	27.3	30.7
	Power input	W	31	46	48
Fan motor	Model		ZKSP-80-8-2		
	Type		DC motor		
	Brand		Nidec/Welling /Yongan		
	Speed <sup>3</sup>	r/min	450/440/410/380 /370/360/330	490/470/440/410 /400/380/350	590/560/530/490 /460/430/400
Indoor coil	Number of rows		2		
	Tube pitch × row pitch	mm	21×13.37		
	Fin spacing	mm	1.5		
	Fin type		Hydrophilic aluminum		
	Tube OD and type	mm	Φ7 Inner-groove		
	Dimensions (L×H×W)	mm	1961×168		
	Number of circuits		8		
Air flow rate <sup>3</sup>		m <sup>3</sup> /h	1029/957/899/857/801 /756/704	1200/1132/1065/996 /920/866/748	1264/1195/1117/1055 /975/893/811
Sound pressure level <sup>4</sup>		dB(A)	43/41/39/38/36/35/34	45/43/41/39/37/35/34	46/44/42/40/38/36/35
Sound power level		dB(A)	56/54/52/51/49/48/47	58/56/54/52/50/48/47	60/58/56/54/52/50/49
Main body	Net dimensions <sup>5</sup> (W×H×D)		840×230×840		
	Packed dimensions (W×H×D)		955×260×955		
	Net/Gross weight		23.2/27.6		
Panel	Net dimensions (W×H×D)		950×54.5×950		
	Packed dimensions (W×H×D)		1035×90×1035		
	Net/Gross weight		5/8		
Refrigerant type			R410A		
Throttle	Type		Electronic expansion valve		
	Model		D20MISZ-1R(L)		
Design pressure (H/L)		MPa	4.4/2.6		
Pipe connections	Liquid/Gas pipe		Φ9.53/Φ15.9		
	Drain pipe		OD Φ32		

## Notes:

- Indoor temperature 27°C DB, 19°C WB; outdoor temperature 35°C DB; equivalent refrigerant piping length 7.5m with zero level difference.
- Indoor temperature 20°C DB; outdoor temperature 7°C DB, 6°C WB; equivalent refrigerant piping length 7.5m with zero level difference.
- Fan motor speed and air flow rate are from the highest speed to the lowest speed, total 7 rates for each model.
- Sound pressure level is from highest level to lowest level, total 7 levels for each model. Sound pressure level is measured 1.4m below the unit in a semi-anechoic chamber.
- Unit body dimensions given are the largest external dimensions of the unit, including hanger attachments.

## SDV5-90CA / SDV5-100CA

Table 1.3: SDV5-90-100CA specifications

Model			SDV5-90CA	SDV5-100CA
Power supply			1 phase, 220-240V, 50Hz	
Cooling <sup>1</sup>	Capacity	kW	9.0	10.0
		kBtu/h	30.7	34.1
	Power input	W	75	75
Heating <sup>2</sup>	Capacity	kW	10.0	11.0
		kBtu/h	34.1	37.5
	Power input	W	75	75
Fan motor	Model		ZKSP-170-8-6	
	Type		DC motor	
	Brand		Nidec/Welling /Yongan	
	Speed <sup>3</sup>	r/min	490/470/450/440/410/380/360	590/560/520/480/450/435/420
Indoor coil	Number of rows		2	2
	Tube pitch × row pitch	mm	21×13.37	
	Fin spacing	mm	1.5	
	Fin type		Hydrophilic aluminum	
	Tube OD and type	mm	Φ7 Inner-groove	
	Dimensions (L×H×W)	mm	1955×252	
	Number of circuits		8	
Air flow rate <sup>3</sup>		m <sup>3</sup> /h	1596/1477/1365/1239/1154/1087/1034	
Sound pressure level <sup>4</sup>		dB(A)	47/45/43/41/39/37/36	
Sound power level		dB(A)	61/59/57/55/53/51/50	
Main body	Net dimensions <sup>5</sup> (W×H×D)		mm 840×300×840	
	Packed dimensions (W×H×D)		mm 955×330×955	
	Net/Gross weight		kg 28.4/33.8	
Panel	Net dimensions (W×H×D)		mm 950×54.5×950	
	Packed dimensions (W×H×D)		mm 1035×90×1035	
	Net/Gross weight		kg 5/8	
Refrigerant type			R410A	
Throttle		Type	Electronic expansion valve	
		Model	D20MISZ-1R(L)	
Design pressure (H/L)		MPa	4.4/2.6	
Pipe connections	Liquid/Gas pipe	mm	Φ9.53/Φ15.9	
	Drain pipe	mm	OD Φ32	

Notes:

1. Indoor temperature 27°C DB, 19°C WB; outdoor temperature 35°C DB; equivalent refrigerant piping length 7.5m with zero level difference.
2. Indoor temperature 20°C DB; outdoor temperature 7°C DB, 6°C WB; equivalent refrigerant piping length 7.5m with zero level difference.
3. Fan motor speed and air flow rate are from the highest speed to the lowest speed, total 7 rates for each model.
4. Sound pressure level is from highest level to lowest level, total 7 levels for each model. Sound pressure level is measured 1.4m below the unit in a semi-anechoic chamber.
5. Unit body dimensions given are the largest external dimensions of the unit, including hanger attachments.

Table 1.4: SDV5-112-140CA specifications

Model			SDV5-112CA	SDV5-140CA
Power supply			1 phase, 220-240V, 50Hz	
Cooling <sup>1</sup>	Capacity	kW	11.2	14.0
		kBtu/h	38.2	47.8
	Power input	W	75	94
Heating <sup>2</sup>	Capacity	kW	12.5	16.0
		kBtu/h	42.7	54.6
	Power input	W	75	94
Fan motor	Model		ZKSP-170-8-6	
	Type		DC motor	
	Brand		Nidec/Welling /Yongan	
	Speed <sup>3</sup>	r/min	590/560/520/480/450/435/420	620/590/550/510/480/465/450
Indoor coil	Number of rows		2	3
	Tube pitch × row pitch	mm	21×13.37	
	Fin spacing	mm	1.5	
	Fin type		Hydrophilic aluminum	
	Tube OD and type	mm	Φ7 Inner-groove	
	Dimensions (L×H×W)	mm	1955×252	
	Number of circuits		8	
Air flow rate <sup>3</sup>		m <sup>3</sup> /h	1596/1477/1365/1239/1154/1087/1034	1727/1622/1517/1426/1351/1289/1224
Sound pressure level <sup>4</sup>		dB(A)	47/45/43/41/39/37/36	50/48/46/45/41/39/38
Sound power level		dB(A)	61/59/57/55/53/51/50	64/62/60/59/55/53/52
Main body	Net dimensions <sup>5</sup> (W×H×D)		840×300×840	
	Packed dimensions (W×H×D)		955×330×955	
	Net/Gross weight		28.4/33.8	30.7/35.8
Panel	Net dimensions (W×H×D)		950×54.5×950	
	Packed dimensions (W×H×D)		1035×90×1035	
	Net/Gross weight		5/8	
Refrigerant type			R410A	
Throttle	Type		Electronic expansion valve	
	Model		D20MISZ-1R(L)	BD24FKS(L)
Design pressure (H/L)		MPa	4.4/2.6	
Pipe connections	Liquid/Gas pipe		Φ9.53/Φ15.9	
	Drain pipe		OD Φ32	

## Notes:

- Indoor temperature 27°C DB, 19°C WB; outdoor temperature 35°C DB; equivalent refrigerant piping length 7.5m with zero level difference.
- Indoor temperature 20°C DB; outdoor temperature 7°C DB, 6°C WB; equivalent refrigerant piping length 7.5m with zero level difference.
- Fan motor speed and air flow rate are from the highest speed to the lowest speed, total 7 rates for each model.
- Sound pressure level is from highest level to lowest level, total 7 levels for each model. Sound pressure level is measured 1.4m below the unit in a semi-anechoic chamber.
- Unit body dimensions given are the largest external dimensions of the unit, including hanger attachments.

## 2 Dimensions

### 2.1 Unit Dimensions

Figure 2.1: Four-way Cassette dimensions (unit: mm)

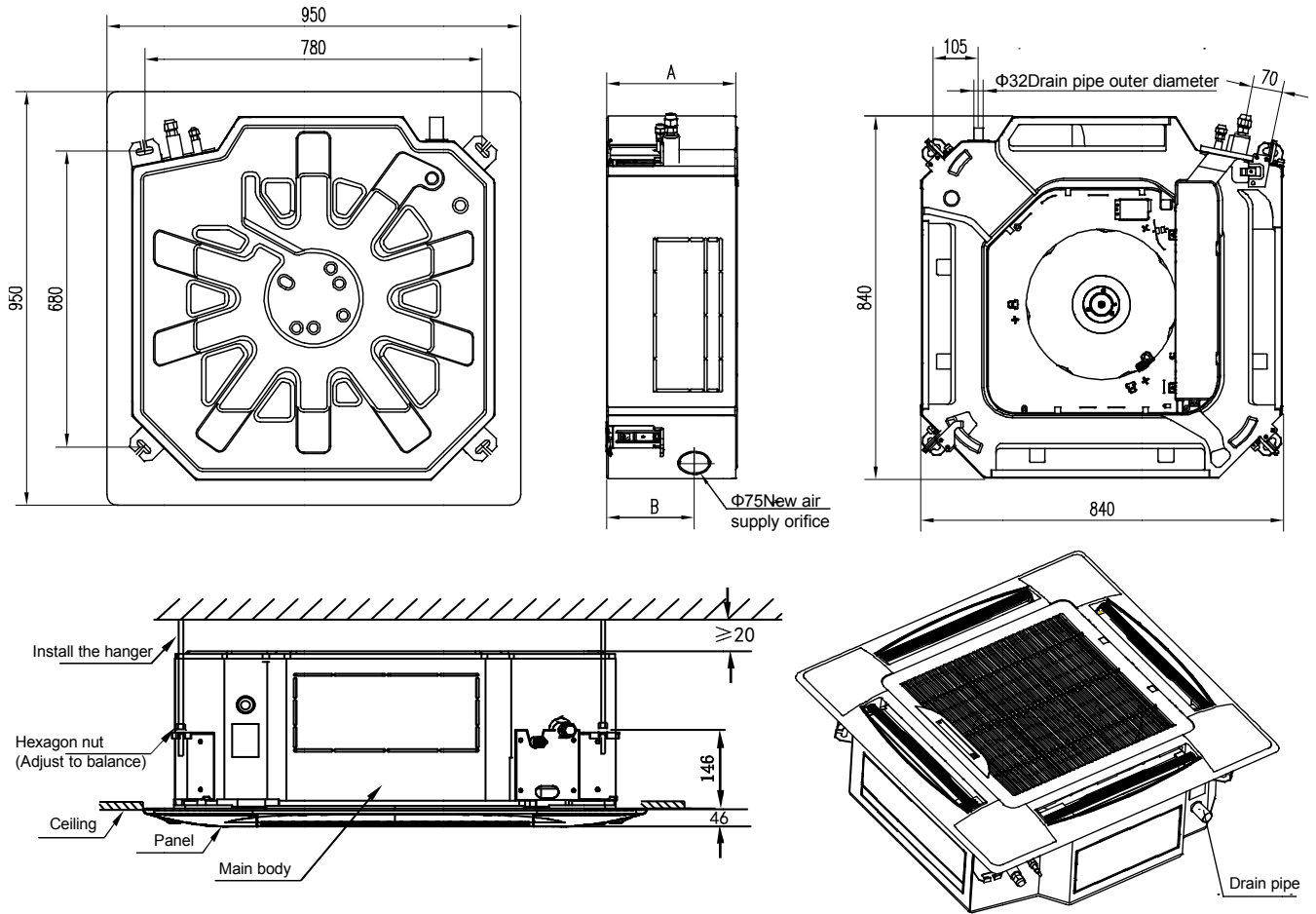

Table 2.1: Four-way Cassette dimensions

Model names	Dimensions (mm)	
	A	B
SDV5-56CA SDV5-71CA SDV5-80CA	230	126
SDV5-90CA SDV5-100CA SDV5-112CA SDV5-140CA	300	197

Table 2.2: Four-way Cassette piping connections

Model names	Gas pipe (mm)	Liquid pipe (mm)
SDV5-56CA SDV5-71CA SDV5-80CA SDV5-90CA SDV5-100CA SDV5-112CA SDV5-140CA	$\Phi 15.9$	$\Phi 9.53$

## 3 Unit Placement

### 3.1 Placement Considerations

Unit placement should take account of the following considerations:

- Units should not be installed in the following locations:
  - Where exposure to direct radiation from a high-temperature heat source or to interference from a source of electromagnetic radiation may occur.
  - Where dust or dirt may affect heat exchangers.
  - Where exposure to oil or to corrosive or harmful gases, such as acidic or alkaline gases, may occur.
  - Where exposure to salinity may occur, such as seaside locations.
  - Where highly flammable materials are present.
  - Where exposure to oily air may occur, such as a kitchen.
  - Where exposure to very high humidity may occur, such as a laundry.
- Units should be installed in positions where:
  - The ceiling is horizontal and is able to bear the unit's weight.
  - There are no obstructions that could impede the airflow into and out of the unit.
  - The airflow out of the unit can reach throughout the room.
  - There is sufficient space for access during installation, servicing and maintenance.
  - The refrigerant piping and drain piping can be easily connected to the refrigerant piping and drain piping systems.
  - Short-circuit ventilation (where outlet air returns quickly to a unit's air inlet) will not occur.

### 3.2 Space Requirements

Figure 3.1: Four-way Cassette space requirements (unit: mm)

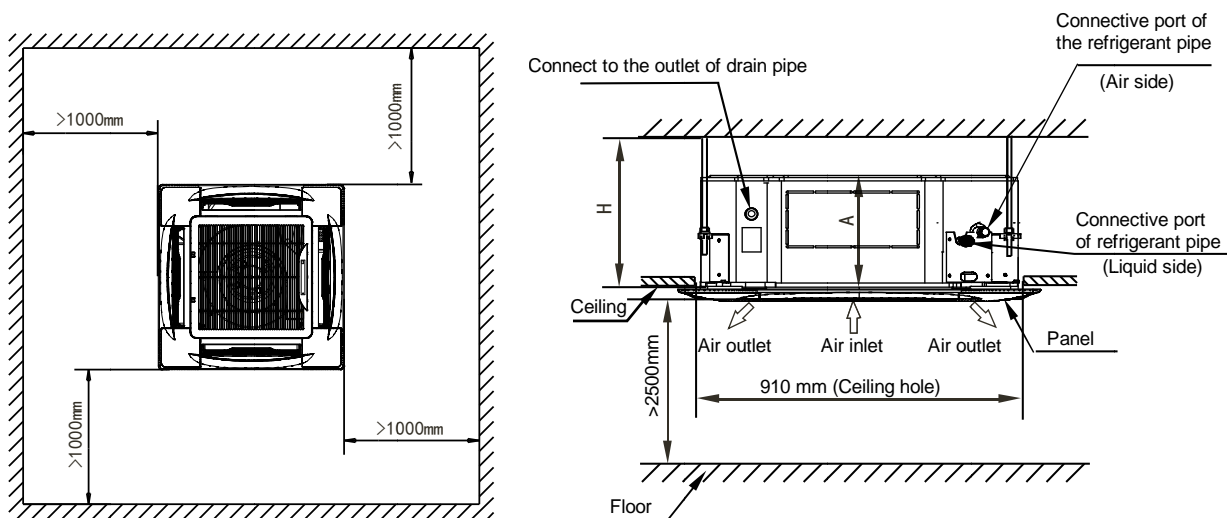



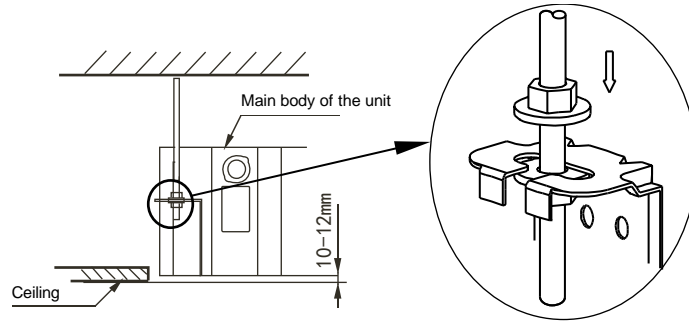
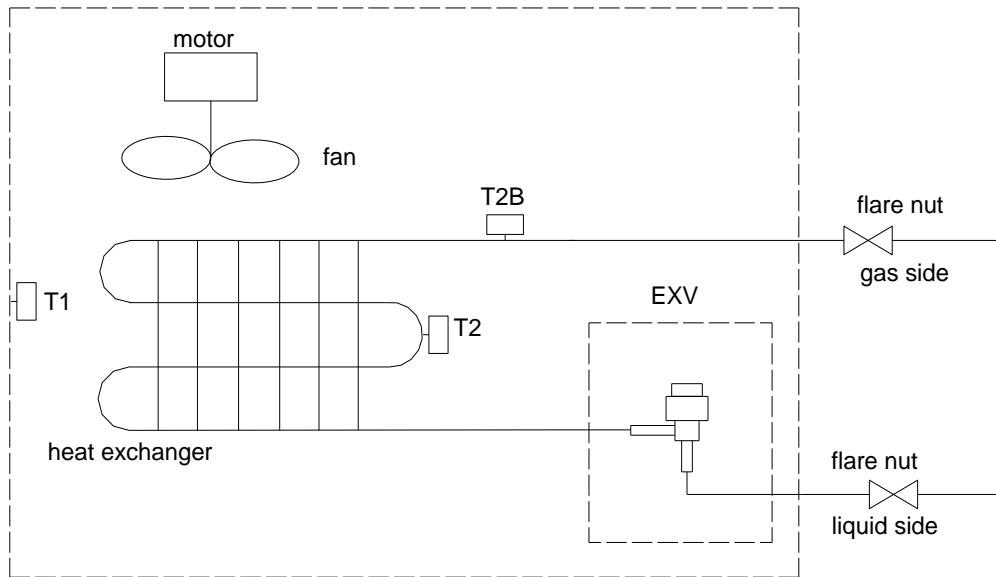

Table 3.1: Four-way Cassette dimensions and space requirements

Model name	Dimensions / Requirements (mm)	
	A	H
SDV5-56CA SDV5-71CA SDV5-80CA	230	≥260
SDV5-90CA SDV5-100CA SDV5-112CA SDV5-140CA	300	≥330

## 4 Piping Diagram

Figure 4.1: Four-way Cassette piping diagram



Legend	
T1	Indoor ambient temperature sensor
T2	Indoor heat exchanger mid-point temperature sensor
T2B	Indoor heat exchanger outlet temperature sensor

# 5 Wiring Diagram

Figure 5.1: SDV5-56CA, SDV5-71CA, SDV5-80CA

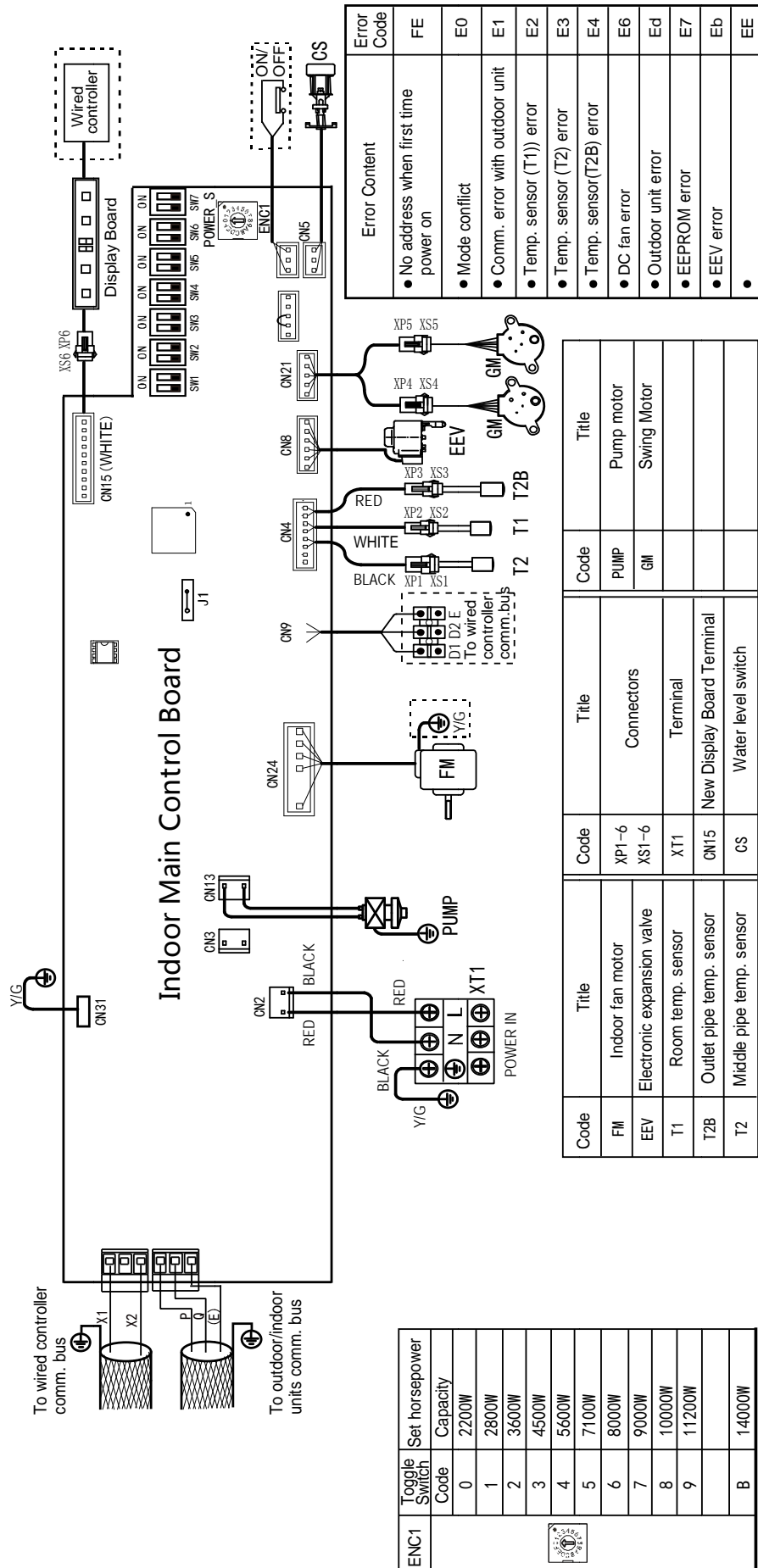
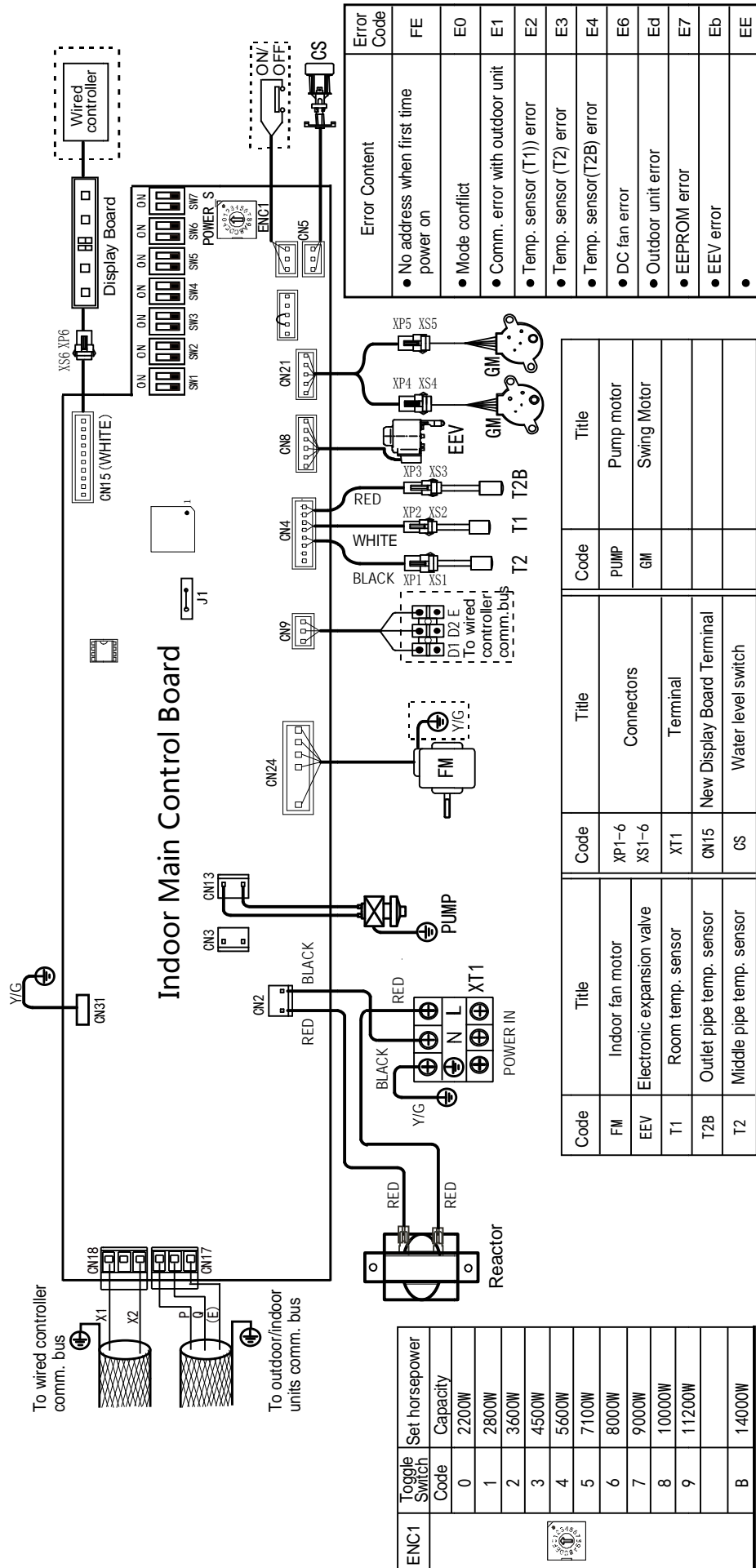

Figure 5.2: SDV5-90CA, SDV5-100CA, SDV5-112CA, SDV5-140CA



**Caution**

- All installation, servicing and maintenance must be carried out by competent and suitably qualified, certified and accredited professionals and in accordance with all applicable legislation.
- Units should be grounded in accordance with all applicable legislation. Metal and other conductive components should be insulated in accordance with all applicable legislation.
- Power supply wiring should be securely fastened at the power supply terminals – loose power supply wiring would represent a fire risk.
- After installation, servicing or maintenance, the electric control box cover should be closed. Failing to close the electric control box cover risks fire or electric shock.
- Switch ENC1 (indoor unit capacity setting) is factory-set and its setting should normally not be changed. The only circumstances in which a switch ENC1 might need to be set in the field is when replacing a main PCB. When replacing a main PCB, ensure that the capacity setting on switch ENC1 on the new PCB is consistent with the unit capacity given on the unit's nameplate.

## 6 Capacity Tables

### 6.1 Cooling Capacity Table

Table 6.1: Four-way Cassette cooling capacity

Capacity (kW)	Outdoor air temperature (°C DB)	Indoor air temperature (°C WB/DB)													
		14/20		16/23		18/26		19/27		20/28		22/30		24/32	
		TC	SC	TC	SC	TC	SC	TC	SC	TC	SC	TC	SC	TC	SC
		kW	kW	kW	kW	kW	kW	kW	kW	kW	kW	kW	kW	kW	kW
2.8	10.0	1.9	1.6	2.3	1.8	2.6	1.9	2.8	1.9	3.0	1.9	3.3	2.0	3.7	2.0
	12.0	1.9	1.6	2.3	1.8	2.6	1.9	2.8	1.9	3.0	1.9	3.3	2.0	3.6	2.0
	14.0	1.9	1.6	2.3	1.8	2.6	1.9	2.8	1.9	3.0	1.9	3.3	2.0	3.6	2.0
	16.0	1.9	1.6	2.3	1.8	2.6	1.9	2.8	1.9	3.0	1.9	3.3	2.0	3.5	1.9
	18.0	1.9	1.6	2.3	1.8	2.6	1.9	2.8	1.9	3.0	1.9	3.3	2.0	3.5	1.9
	20.0	1.9	1.6	2.3	1.8	2.6	1.9	2.8	1.9	3.0	1.9	3.3	2.0	3.4	1.9
	21.0	1.9	1.6	2.3	1.8	2.6	1.9	2.8	1.9	3.0	1.9	3.3	2.0	3.4	1.9
	23.0	1.9	1.6	2.3	1.8	2.6	1.9	2.8	1.9	3.0	1.9	3.3	2.0	3.4	1.9
	25.0	1.9	1.6	2.3	1.8	2.6	1.9	2.8	1.9	3.0	1.9	3.2	1.9	3.3	1.9
	27.0	1.9	1.6	2.3	1.8	2.6	1.9	2.8	1.9	3.0	1.9	3.2	1.9	3.3	1.9
	29.0	1.9	1.6	2.3	1.8	2.6	1.9	2.8	1.9	3.0	1.9	3.1	1.8	3.2	1.8
	31.0	1.9	1.6	2.3	1.8	2.6	1.9	2.8	1.9	3.0	1.9	3.1	1.8	3.2	1.7
	33.0	1.9	1.6	2.3	1.8	2.6	1.9	2.8	1.9	3.0	1.9	3.1	1.8	3.1	1.7
	35.0	1.9	1.6	2.3	1.8	2.6	1.9	<b>2.8</b>	1.9	2.9	1.9	3.0	1.8	3.1	1.7
	37.0	1.9	1.6	2.3	1.8	2.6	1.9	2.8	1.9	2.9	1.9	3.0	1.8	3.0	1.7
	39.0	1.9	1.6	2.3	1.8	2.6	1.9	2.8	1.9	2.9	1.9	3.0	1.9	3.0	1.7
42.0	1.9	1.6	2.3	1.8	2.6	1.9	2.8	1.9	2.9	1.9	3.0	1.9	3.0	1.7	
44.0	1.9	1.6	2.3	1.8	2.6	1.9	2.8	1.9	2.9	1.9	3.0	1.9	3.0	1.7	
46.0	1.9	1.6	2.3	1.8	2.6	1.9	2.8	1.9	2.9	1.9	3.0	1.9	3.0	1.7	
3.6	10.0	2.5	1.9	2.9	2.1	3.4	2.3	3.6	2.4	3.8	2.5	4.3	2.4	4.7	2.5
	12.0	2.5	1.9	2.9	2.1	3.4	2.3	3.6	2.4	3.8	2.5	4.3	2.4	4.7	2.5
	14.0	2.5	1.9	2.9	2.1	3.4	2.3	3.6	2.4	3.8	2.5	4.3	2.4	4.6	2.4
	16.0	2.5	1.9	2.9	2.1	3.4	2.3	3.6	2.4	3.8	2.5	4.3	2.4	4.5	2.4
	18.0	2.5	1.9	2.9	2.1	3.4	2.3	3.6	2.4	3.8	2.5	4.3	2.4	4.5	2.4
	20.0	2.5	1.9	2.9	2.1	3.4	2.3	3.6	2.4	3.8	2.5	4.3	2.4	4.4	2.3
	21.0	2.5	1.9	2.9	2.1	3.4	2.3	3.6	2.4	3.8	2.5	4.3	2.4	4.4	2.3
	23.0	2.5	1.9	2.9	2.1	3.4	2.3	3.6	2.4	3.8	2.5	4.1	2.3	4.3	2.2
	25.0	2.5	1.9	2.9	2.1	3.4	2.3	3.6	2.4	3.8	2.5	4.1	2.3	4.2	2.2
	27.0	2.5	1.9	2.9	2.1	3.4	2.3	3.6	2.4	3.8	2.5	4.0	2.2	4.2	2.2
	29.0	2.5	1.9	2.9	2.1	3.4	2.3	3.6	2.4	3.8	2.5	4.0	2.2	4.1	2.2
	31.0	2.5	1.9	2.9	2.1	3.4	2.3	3.6	2.4	3.8	2.5	4.2	2.6	4.1	2.2
	33.0	2.5	1.9	2.9	2.1	3.4	2.3	3.6	2.4	3.8	2.5	4.2	2.6	3.9	2.1
	35.0	2.5	1.9	2.9	2.1	3.4	2.3	<b>3.6</b>	2.4	3.8	2.5	4.2	2.6	3.9	2.1
	37.0	2.5	1.9	2.9	2.1	3.4	2.3	3.6	2.4	3.7	2.4	3.8	2.3	3.9	2.1
	39.0	2.5	1.9	2.9	2.1	3.4	2.3	3.6	2.4	3.7	2.4	3.8	2.3	3.8	2.1
42.0	2.5	1.9	2.9	2.1	3.4	2.3	3.6	2.4	3.7	2.4	3.8	2.3	3.8	2.1	
44.0	2.5	1.9	2.9	2.1	3.4	2.3	3.6	2.4	3.7	2.4	3.8	2.3	3.8	2.1	
46.0	2.5	1.9	2.9	2.1	3.4	2.3	3.6	2.4	3.7	2.4	3.8	2.3	3.8	2.1	

Abbreviations:

TC: Total capacity

SC: Sensible capacity

Notes:

1. Shaded cells indicate rating condition.

Table continued on next page ...

Table 6.1: Four-way Cassette cooling capacity (continued)

Capacity (kW)	Outdoor air temperature (°C DB)	Indoor air temperature (°C WB/DB)													
		14/20		16/23		18/26		19/27		20/28		22/30		24/32	
		TC	SC	TC	SC	TC	SC	TC	SC	TC	SC	TC	SC	TC	SC
		kW	kW	kW	kW	kW	kW	kW	kW	kW	kW	kW	kW	kW	kW
4.5	10.0	3.1	2.4	3.7	2.6	4.2	2.8	4.5	2.9	4.8	3.0	5.3	3.4	5.9	3.0
	12.0	3.1	2.4	3.7	2.6	4.2	2.8	4.5	2.9	4.8	3.0	5.3	3.4	5.9	3.0
	14.0	3.1	2.4	3.7	2.6	4.2	2.8	4.5	2.9	4.8	3.0	5.3	3.4	5.8	3.0
	16.0	3.1	2.4	3.7	2.6	4.2	2.8	4.5	2.9	4.8	3.0	5.3	3.4	5.6	2.9
	18.0	3.1	2.4	3.7	2.6	4.2	2.8	4.5	2.9	4.8	3.0	5.3	3.4	5.7	3.0
	20.0	3.1	2.4	3.7	2.6	4.2	2.8	4.5	2.9	4.8	3.0	5.3	3.4	5.7	3.0
	21.0	3.1	2.4	3.7	2.6	4.2	2.8	4.5	2.9	4.8	3.0	5.3	3.4	5.6	3.0
	23.0	3.1	2.4	3.7	2.6	4.2	2.8	4.5	2.9	4.8	3.0	5.3	3.4	5.5	3.0
	25.0	3.1	2.4	3.7	2.6	4.2	2.8	4.5	2.9	4.8	3.0	5.2	3.0	5.4	2.9
	27.0	3.1	2.4	3.7	2.6	4.2	2.8	4.5	2.9	4.8	3.0	5.1	3.0	5.2	2.8
	29.0	3.1	2.4	3.7	2.6	4.2	2.8	4.5	2.9	4.8	3.0	5.1	2.9	5.2	2.8
	31.0	3.1	2.4	3.7	2.6	4.2	2.8	4.5	2.9	4.8	3.0	5.0	2.9	5.1	2.7
	33.0	3.1	2.4	3.7	2.6	4.2	2.8	4.5	2.9	4.8	3.0	4.9	2.8	5.1	2.7
	35.0	3.1	2.4	3.7	2.6	4.2	2.8	4.5	2.9	4.8	3.0	4.8	2.8	5.0	2.7
	37.0	3.1	2.4	3.7	2.6	4.2	2.8	4.5	2.9	4.8	3.0	4.8	2.9	4.9	2.6
	39.0	3.1	2.4	3.7	2.6	4.2	2.8	4.5	2.9	4.6	2.8	4.7	2.8	4.8	2.6
42.0	3.1	2.4	3.7	2.6	4.2	2.8	4.5	2.9	4.6	2.8	4.7	2.8	4.8	2.6	
44.0	3.1	2.4	3.7	2.6	4.2	2.8	4.5	2.9	4.6	2.8	4.7	2.8	4.8	2.6	
46.0	3.1	2.4	3.7	2.6	4.2	2.8	4.5	2.9	4.6	2.8	4.7	3.1	4.8	2.6	
5.6	10.0	3.9	2.7	4.6	3.0	5.3	3.3	5.6	3.4	5.9	3.5	6.6	3.6	7.3	3.5
	12.0	3.9	2.7	4.6	3.0	5.3	3.3	5.6	3.4	5.9	3.5	6.6	3.6	7.2	3.5
	14.0	3.9	2.7	4.6	3.0	5.3	3.3	5.6	3.4	5.9	3.5	6.6	3.6	7.1	3.5
	16.0	3.9	2.7	4.6	3.0	5.3	3.3	5.6	3.4	5.9	3.5	6.6	3.6	7.0	3.4
	18.0	3.9	2.7	4.6	3.0	5.3	3.3	5.6	3.4	5.9	3.5	6.6	3.6	6.8	3.4
	20.0	3.9	2.7	4.6	3.0	5.3	3.3	5.6	3.4	5.9	3.5	6.6	3.6	6.7	3.3
	21.0	3.9	2.7	4.6	3.0	5.3	3.3	5.6	3.4	5.9	3.5	6.6	3.6	6.6	3.3
	23.0	3.9	2.7	4.6	3.0	5.3	3.3	5.6	3.4	5.9	3.5	6.6	3.6	6.6	3.3
	25.0	3.9	2.7	4.6	3.0	5.3	3.3	5.6	3.4	5.9	3.5	6.6	3.6	6.5	3.2
	27.0	3.9	2.7	4.6	3.0	5.3	3.3	5.6	3.4	5.9	3.5	6.4	3.5	6.4	3.2
	29.0	3.9	2.7	4.6	3.0	5.3	3.3	5.6	3.4	5.9	3.5	6.3	3.5	6.4	3.3
	31.0	3.9	2.7	4.6	3.0	5.3	3.3	5.6	3.4	5.9	3.5	6.2	3.4	6.2	3.2
	33.0	3.9	2.7	4.6	3.0	5.3	3.3	5.6	3.4	5.9	3.5	6.2	3.4	6.2	3.2
	35.0	3.9	2.7	4.6	3.0	5.3	3.3	5.6	3.4	5.9	3.5	6.0	3.3	6.0	3.1
	37.0	3.9	2.7	4.6	3.0	5.3	3.3	5.6	3.4	5.9	3.5	5.9	3.2	6.0	3.1
	39.0	3.9	2.7	4.6	3.0	5.3	3.3	5.6	3.4	5.7	3.4	5.8	3.2	6.0	3.1
42.0	3.9	2.7	4.6	3.0	5.3	3.3	5.6	3.4	5.7	3.4	5.8	3.2	6.0	3.1	
44.0	3.9	2.7	4.6	3.0	5.3	3.3	5.6	3.4	5.7	3.4	5.8	3.2	6.0	3.1	
46.0	3.9	2.7	4.6	3.0	5.3	3.3	5.6	3.4	5.7	3.7	5.8	3.2	6.0	3.1	

Abbreviations:  
 TC: Total capacity  
 SC: Sensible capacity

Notes:  
 1. Shaded cells indicate rating condition.

Table continued on next page ...

Table 6.1: Four-way Cassette cooling capacity (continued)

Capacity (kW)	Outdoor air temperature (°C DB)	Indoor air temperature (°C WB/DB)													
		14/20		16/23		18/26		19/27		20/28		22/30		24/32	
		TC	SC	TC	SC	TC	SC	TC	SC	TC	SC	TC	SC	TC	SC
		kW	kW	kW	kW	kW	kW	kW	kW	kW	kW	kW	kW	kW	kW
7.1	10.0	4.9	3.6	5.8	4.0	6.7	4.3	7.1	4.5	7.5	4.4	8.4	4.5	9.2	4.6
	12.0	4.9	3.6	5.8	4.0	6.7	4.3	7.1	4.5	7.5	4.4	8.4	4.5	9.1	4.5
	14.0	4.9	3.6	5.8	4.0	6.7	4.3	7.1	4.5	7.5	4.4	8.4	4.5	9.0	4.5
	16.0	4.9	3.6	5.8	4.0	6.7	4.3	7.1	4.5	7.5	4.4	8.4	4.5	8.9	4.4
	18.0	4.9	3.6	5.8	4.0	6.7	4.3	7.1	4.5	7.5	4.4	8.4	4.5	8.7	4.3
	20.0	4.9	3.6	5.8	4.0	6.7	4.3	7.1	4.5	7.5	4.4	8.4	4.5	8.5	4.2
	21.0	4.9	3.6	5.8	4.0	6.7	4.3	7.1	4.5	7.5	4.4	8.4	4.5	8.4	4.2
	23.0	4.9	3.6	5.8	4.0	6.7	4.3	7.1	4.5	7.5	4.4	8.4	4.5	8.3	4.1
	25.0	4.9	3.6	5.8	4.0	6.7	4.3	7.1	4.5	7.5	4.4	8.4	4.5	8.2	4.1
	27.0	4.9	3.6	5.8	4.0	6.7	4.3	7.1	4.5	7.5	4.4	8.1	4.3	8.2	4.1
	29.0	4.9	3.6	5.8	4.0	6.7	4.3	7.1	4.5	7.5	4.5	8.0	4.3	8.1	4.1
	31.0	4.9	3.6	5.8	4.0	6.7	4.3	7.1	4.5	7.5	4.5	7.9	4.3	7.8	4.0
	33.0	4.9	3.6	5.8	4.0	6.7	4.3	7.1	4.5	7.5	4.5	7.8	4.2	7.8	4.0
	35.0	4.9	3.6	5.8	4.0	6.7	4.3	7.1	4.5	7.5	4.5	7.6	4.1	7.7	3.9
	37.0	4.9	3.6	5.8	4.0	6.7	4.3	7.1	4.5	7.4	4.4	7.5	4.1	7.6	4.0
	39.0	4.9	3.6	5.8	4.0	6.7	4.3	7.1	4.5	7.2	4.3	7.4	4.1	7.6	4.0
	42.0	4.9	3.6	5.8	4.0	6.7	4.3	7.1	4.5	7.2	4.3	7.4	4.1	7.6	4.0
44.0	4.9	3.6	5.8	4.0	6.7	4.3	7.1	4.5	7.2	4.3	7.4	4.1	7.6	4.0	
46.0	4.9	3.6	5.8	4.0	6.7	4.3	7.1	4.5	7.2	4.3	7.4	4.1	7.6	4.0	
8.0	10.0	5.5	4.4	6.6	4.9	7.5	5.3	8.0	5.5	8.4	5.4	9.4	5.5	10.4	5.6
	12.0	5.5	4.4	6.6	4.9	7.5	5.3	8.0	5.5	8.4	5.4	9.4	5.5	10.2	5.5
	14.0	5.5	4.4	6.6	4.9	7.5	5.3	8.0	5.5	8.4	5.4	9.4	5.5	10.2	5.5
	16.0	5.5	4.4	6.6	4.9	7.5	5.3	8.0	5.5	8.4	5.4	9.4	5.5	10.0	5.4
	18.0	5.5	4.4	6.6	4.9	7.5	5.3	8.0	5.5	8.4	5.4	9.4	5.5	9.8	5.3
	20.0	5.5	4.4	6.6	4.9	7.5	5.3	8.0	5.5	8.4	5.4	9.4	5.5	9.6	5.2
	21.0	5.5	4.4	6.6	4.9	7.5	5.3	8.0	5.5	8.4	5.4	9.4	5.5	9.4	5.1
	23.0	5.5	4.4	6.6	4.9	7.5	5.3	8.0	5.5	8.4	5.4	9.4	5.5	9.4	5.1
	25.0	5.5	4.4	6.6	4.9	7.5	5.3	8.0	5.5	8.4	5.4	9.4	5.5	9.3	5.0
	27.0	5.5	4.4	6.6	4.9	7.5	5.3	8.0	5.5	8.4	5.4	9.1	5.3	9.2	5.1
	29.0	5.5	4.4	6.6	4.9	7.5	5.3	8.0	5.5	8.4	5.5	9.0	5.3	9.1	5.0
	31.0	5.5	4.4	6.6	4.9	7.5	5.3	8.0	5.5	8.4	5.5	8.9	5.2	8.8	4.8
	33.0	5.5	4.4	6.6	4.9	7.5	5.3	8.0	5.5	8.4	5.5	8.8	5.2	8.8	4.8
	35.0	5.5	4.4	6.6	4.9	7.5	5.3	8.0	5.5	8.4	5.5	8.6	5.1	8.6	4.8
	37.0	5.5	4.4	6.6	4.9	7.5	5.3	8.0	5.5	8.3	5.4	8.4	5.0	8.6	4.9
	39.0	5.5	4.4	6.6	4.9	7.5	5.3	8.0	5.5	8.1	5.3	8.3	5.0	8.6	4.9
	42.0	5.5	4.4	6.6	4.9	7.5	5.3	8.0	5.5	8.1	5.3	8.3	5.0	8.6	4.9
44.0	5.5	4.4	6.6	4.9	7.5	5.3	8.0	5.5	8.1	5.3	8.3	5.0	8.6	4.9	
46.0	5.5	4.4	6.6	4.9	7.5	5.3	8.0	5.5	8.1	5.3	8.3	5.0	8.6	4.9	

Abbreviations:  
 TC: Total capacity  
 SC: Sensible capacity

Notes:  
 1. Shaded cells indicate rating condition.

Table continued on next page ...



Table 6.1: Four-way Cassette cooling capacity (continued)

Capacity (kW)	Outdoor air temperature (°C DB)	Indoor air temperature (°C WB/DB)													
		14/20		16/23		18/26		19/27		20/28		22/30		24/32	
		TC	SC	TC	SC	TC	SC	TC	SC	TC	SC	TC	SC	TC	SC
		kW	kW	kW	kW	kW	kW	kW	kW	kW	kW	kW	kW	kW	kW
9.0	10.0	6.2	4.9	7.3	5.3	8.4	5.8	9.0	5.9	9.6	6.0	10.6	6.1	11.7	6.0
	12.0	6.2	4.9	7.3	5.3	8.4	5.8	9.0	5.9	9.6	6.0	10.6	6.1	11.5	5.9
	14.0	6.2	4.9	7.3	5.3	8.4	5.8	9.0	5.9	9.6	6.0	10.6	6.1	11.4	5.9
	16.0	6.2	4.9	7.3	5.3	8.4	5.8	9.0	5.9	9.6	6.0	10.6	6.1	11.3	5.8
	18.0	6.2	4.9	7.3	5.3	8.4	5.8	9.0	5.9	9.6	6.0	10.6	6.1	11.0	5.8
	20.0	6.2	4.9	7.3	5.3	8.4	5.8	9.0	5.9	9.6	6.0	10.6	6.1	10.8	5.7
	21.0	6.2	4.9	7.3	5.3	8.4	5.8	9.0	5.9	9.6	6.0	10.6	6.1	10.6	5.6
	23.0	6.2	4.9	7.3	5.3	8.4	5.8	9.0	5.9	9.6	6.0	10.6	6.1	10.5	5.5
	25.0	6.2	4.9	7.3	5.3	8.4	5.8	9.0	5.9	9.6	6.0	10.6	6.1	10.4	5.5
	27.0	6.2	4.9	7.3	5.3	8.4	5.8	9.0	5.9	9.6	6.0	10.3	5.9	10.4	5.4
	29.0	6.2	4.9	7.3	5.3	8.4	5.8	9.0	5.9	9.6	6.0	10.1	5.7	10.3	5.4
	31.0	6.2	4.9	7.3	5.3	8.4	5.8	9.0	5.9	9.6	6.0	10.0	5.7	9.9	5.3
	33.0	6.2	4.9	7.3	5.3	8.4	5.8	9.0	5.9	9.6	6.0	9.9	5.6	9.9	5.3
	35.0	6.2	4.9	7.3	5.3	8.4	5.8	9.0	5.9	9.5	6.0	9.6	5.5	9.7	5.3
	37.0	6.2	4.9	7.3	5.3	8.4	5.8	9.0	5.9	9.3	5.8	9.5	5.4	9.6	5.3
	39.0	6.2	4.9	7.3	5.3	8.4	5.8	9.0	5.9	9.2	5.7	9.4	5.3	9.6	5.3
42.0	6.2	4.9	7.3	5.3	8.4	5.8	9.0	5.9	9.2	5.7	9.4	5.3	9.6	5.3	
44.0	6.2	4.9	7.3	5.3	8.4	5.8	9.0	5.9	9.2	5.7	9.4	5.3	9.6	5.3	
46.0	6.2	4.9	7.3	5.3	8.4	5.8	9.0	5.9	9.2	5.7	9.4	5.3	9.6	5.3	
10.0	10.0	6.9	5.6	8.1	6.2	9.4	6.9	10.0	7.0	10.6	7.0	11.9	7.3	13.0	7.3
	12.0	6.9	5.6	8.1	6.2	9.4	6.9	10.0	7.0	10.6	7.0	11.9	7.3	12.8	7.2
	14.0	6.9	5.6	8.1	6.2	9.4	6.9	10.0	7.0	10.6	7.0	11.9	7.3	12.7	7.1
	16.0	6.9	5.6	8.1	6.2	9.4	6.9	10.0	7.0	10.6	7.0	11.9	7.3	12.5	7.0
	18.0	6.9	5.6	8.1	6.2	9.4	6.9	10.0	7.0	10.6	7.0	11.9	7.3	12.2	6.8
	20.0	6.9	5.6	8.1	6.2	9.4	6.9	10.0	7.0	10.6	7.0	11.9	7.3	12.0	6.7
	21.0	6.9	5.6	8.1	6.2	9.4	6.9	10.0	7.0	10.6	7.0	11.9	7.3	11.8	6.6
	23.0	6.9	5.6	8.1	6.2	9.4	6.9	10.0	7.0	10.6	7.0	11.7	7.3	11.7	6.6
	25.0	6.9	5.6	8.1	6.2	9.4	6.9	10.0	7.0	10.6	7.0	11.6	7.2	11.6	6.5
	27.0	6.9	5.6	8.1	6.2	9.4	6.9	10.0	7.0	10.6	7.0	11.5	7.1	11.5	6.6
	29.0	6.9	5.6	8.1	6.2	9.4	6.9	10.0	7.0	10.6	7.0	11.4	7.1	11.4	6.5
	31.0	6.9	5.6	8.1	6.2	9.4	6.9	10.0	7.0	10.6	7.0	11.3	7.0	11.0	6.3
	33.0	6.9	5.6	8.1	6.2	9.4	6.9	10.0	7.0	10.6	7.0	11.2	6.9	11.0	6.3
	35.0	6.9	5.6	8.1	6.2	9.4	6.9	10.0	7.0	10.5	6.9	10.8	6.7	10.8	6.3
	37.0	6.9	5.6	8.1	6.2	9.4	6.9	10.0	7.0	10.4	6.9	10.8	6.7	10.7	6.2
	39.0	6.9	5.6	8.1	6.2	9.4	6.9	10.0	7.0	10.2	6.7	10.4	6.6	10.7	6.3
42.0	6.9	5.6	8.1	6.2	9.4	6.9	10.0	7.0	10.2	6.7	10.4	6.6	10.7	6.3	
44.0	6.9	5.6	8.1	6.2	9.4	6.9	10.0	7.0	10.2	6.7	10.4	6.6	10.7	6.3	
46.0	6.9	5.6	8.1	6.2	9.4	6.9	10.0	7.0	10.2	6.7	10.4	6.6	10.7	6.3	

Abbreviations:  
 TC: Total capacity  
 SC: Sensible capacity

Notes:  
 1. Shaded cells indicate rating condition.

Table continued on next page ...

Table 6.1: Four-way Cassette cooling capacity (continued)

Capacity (kW)	Outdoor air temperature (°C DB)	Indoor air temperature (°C WB/DB)													
		14/20		16/23		18/26		19/27		20/28		22/30		24/32	
		TC	SC	TC	SC	TC	SC	TC	SC	TC	SC	TC	SC	TC	SC
		kW	kW	kW	kW	kW	kW	kW	kW	kW	kW	kW	kW	kW	kW
11.2	10.0	7.7	5.9	9.1	6.5	10.5	7.1	11.2	7.2	11.9	7.4	13.3	7.6	15.5	8.2
	12.0	7.7	5.9	9.1	6.5	10.5	7.1	11.2	7.2	11.9	7.4	13.3	7.6	14.4	7.7
	14.0	7.7	5.9	9.1	6.5	10.5	7.1	11.2	7.2	11.9	7.4	13.3	7.6	14.2	7.6
	16.0	7.7	5.9	9.1	6.5	10.5	7.1	11.2	7.2	11.9	7.4	13.3	7.6	14.1	7.5
	18.0	7.7	5.9	9.1	6.5	10.5	7.1	11.2	7.2	11.9	7.4	13.3	7.6	14.0	7.5
	20.0	7.7	5.9	9.1	6.5	10.5	7.1	11.2	7.2	11.9	7.4	13.3	7.6	13.9	7.4
	21.0	7.7	5.9	9.1	6.5	10.5	7.1	11.2	7.2	11.9	7.4	13.3	7.6	13.8	7.4
	23.0	7.7	5.9	9.1	6.5	10.5	7.1	11.2	7.2	11.9	7.4	13.1	7.5	13.7	7.3
	25.0	7.7	5.9	9.1	6.5	10.5	7.1	11.2	7.2	11.9	7.4	13.0	7.4	13.6	7.2
	27.0	7.7	5.9	9.1	6.5	10.5	7.1	11.2	7.2	11.9	7.4	12.9	7.3	13.4	7.2
	29.0	7.7	5.9	9.1	6.5	10.5	7.1	11.2	7.2	11.9	7.4	12.8	7.3	13.3	7.2
	31.0	7.7	5.9	9.1	6.5	10.5	7.1	11.2	7.2	11.9	7.4	12.7	7.2	12.8	6.9
	33.0	7.7	5.9	9.1	6.5	10.5	7.1	11.2	7.2	11.9	7.4	12.5	7.2	12.5	6.8
	35.0	7.7	5.9	9.1	6.5	10.5	7.1	11.2	7.2	11.8	7.4	12.4	7.1	12.3	6.7
	37.0	7.7	5.9	9.1	6.5	10.5	7.1	11.2	7.2	11.6	7.3	12.3	7.0	12.1	6.6
	39.0	7.7	5.9	9.1	6.5	10.5	7.1	11.2	7.2	11.4	7.1	12.2	7.0	11.9	6.6
42.0	7.7	6.0	9.1	6.6	10.4	7.2	11.2	7.3	11.4	7.1	11.6	6.6	12.0	6.6	
44.0	7.7	6.0	9.1	6.6	10.4	7.2	11.2	7.3	11.4	7.1	11.6	6.6	12.0	6.6	
46.0	7.7	6.0	9.1	6.6	10.4	7.2	11.2	7.3	11.4	7.1	11.6	6.6	12.0	6.6	
14.0	10.0	9.7	7.2	11.3	7.9	13.2	8.8	14.0	9.0	14.8	9.0	16.7	9.3	18.2	9.4
	12.0	9.7	7.2	11.3	7.9	13.2	8.8	14.0	9.0	14.8	9.0	16.7	9.3	17.9	9.2
	14.0	9.7	7.2	11.3	7.9	13.2	8.8	14.0	9.0	14.8	9.0	16.7	9.3	17.8	9.2
	16.0	9.7	7.2	11.3	7.9	13.2	8.8	14.0	9.0	14.8	9.0	16.7	9.3	17.5	9.0
	18.0	9.7	7.2	11.3	7.9	13.2	8.8	14.0	9.0	14.8	9.0	16.7	9.3	17.1	8.8
	20.0	9.7	7.2	11.3	7.9	13.2	8.8	14.0	9.0	14.8	9.0	16.7	9.3	16.8	8.7
	21.0	9.7	7.2	11.3	7.9	13.2	8.8	14.0	9.0	14.8	9.0	16.7	9.3	16.5	8.5
	23.0	9.7	7.2	11.3	7.9	13.2	8.8	14.0	9.0	14.8	9.0	16.4	9.3	16.4	8.4
	25.0	9.7	7.2	11.3	7.9	13.2	8.8	14.0	9.0	14.8	9.0	16.2	9.3	16.2	8.4
	27.0	9.7	7.2	11.3	7.9	13.2	8.8	14.0	9.0	14.8	9.0	16.1	9.2	16.1	8.4
	29.0	9.7	7.2	11.3	7.9	13.2	8.8	14.0	9.0	14.8	9.0	16.0	9.1	16.0	8.4
	31.0	9.7	7.2	11.3	7.9	13.2	8.8	14.0	9.0	14.8	9.0	15.8	9.0	15.4	8.1
	33.0	9.7	7.2	11.3	7.9	13.2	8.8	14.0	9.0	14.8	9.0	15.7	8.9	15.4	8.1
	35.0	9.7	7.2	11.3	7.9	13.2	8.8	14.0	9.0	14.7	8.9	15.1	8.6	15.1	8.1
	37.0	9.7	7.2	11.3	7.9	13.2	8.8	14.0	9.0	14.6	8.8	15.1	8.6	15.0	8.0
	39.0	9.7	7.2	11.3	7.9	13.2	8.8	14.0	9.0	14.3	8.7	14.6	8.4	15.0	8.1
42.0	9.7	7.2	11.3	7.9	13.2	8.8	14.0	9.0	14.3	8.7	14.6	8.4	15.0	8.1	
44.0	9.7	7.2	11.3	7.9	13.2	8.8	14.0	9.0	14.3	8.7	14.6	8.4	15.0	8.1	
46.0	9.7	7.2	11.3	7.9	13.2	8.8	14.0	9.0	14.3	8.7	14.6	8.4	15.0	8.1	

Abbreviations:  
 TC: Total capacity  
 SC: Sensible capacity

Notes:  
 1. Shaded cells indicate rating condition.

## 6.2 Heating Capacity Table

Table 6.2: Four-way Cassette heating capacity

Capacity (kW)	Outdoor air temperature (°C)		Indoor air temperature (°C DB)					
			16	18	20	21	22	24
	WB	DB	TC	TC	TC	TC	TC	TC
2.8	-20	-19.8	1.79	1.79	1.79	1.79	1.79	1.79
	-19	-18.8	1.92	1.92	1.92	1.92	1.92	1.92
	-17	-16.7	2.02	2.02	2.02	2.02	2.02	2.02
	-15	-14.7	2.02	2.02	2.02	2.02	2.02	2.02
	-13.00	-12.60	2.14	2.14	2.14	2.14	2.14	2.14
	-11.00	-10.50	2.24	2.24	2.24	2.24	2.24	2.24
	-10.00	-9.50	2.34	2.34	2.34	2.34	2.34	2.34
	-9.10	-8.50	2.40	2.40	2.40	2.40	2.40	2.40
	-7.60	-7.00	2.43	2.43	2.43	2.43	2.43	2.43
	-5.60	-5.00	2.53	2.53	2.53	2.53	2.53	2.53
	-3.70	-3.00	2.66	2.66	2.66	2.66	2.66	2.66
	-0.70	0.00	2.85	2.85	2.85	2.85	2.85	2.69
	2.20	3.00	3.01	3.01	3.01	3.01	2.94	2.69
	4.10	5.00	3.10	3.10	3.10	3.10	2.94	2.69
	6.00	7.00	3.20	3.20	3.20	3.10	2.94	2.69
	7.90	9.00	3.30	3.30	3.20	3.10	2.94	2.69
9.80	11.00	3.39	3.39	3.20	3.10	2.94	2.69	
11.80	13.00	3.52	3.46	3.20	3.10	2.94	2.69	
13.70	15.00	3.62	3.46	3.20	3.10	2.94	2.69	
3.6	-20	-19.8	2.24	2.24	2.24	2.24	2.24	2.24
	-19	-18.8	2.40	2.40	2.40	2.40	2.40	2.40
	-17	-16.7	2.52	2.52	2.52	2.52	2.52	2.52
	-15	-14.7	2.60	2.60	2.60	2.60	2.60	2.60
	-13.00	-12.60	2.68	2.68	2.68	2.68	2.68	2.68
	-11.00	-10.50	2.80	2.80	2.80	2.80	2.80	2.80
	-10.00	-9.50	2.92	2.92	2.92	2.92	2.92	2.92
	-9.10	-8.50	3.00	3.00	3.00	3.00	3.00	3.00
	-7.60	-7.00	3.04	3.04	3.04	3.04	3.04	3.04
	-5.60	-5.00	3.16	3.16	3.16	3.16	3.16	3.16
	-3.70	-3.00	3.32	3.32	3.32	3.32	3.32	3.32
	-0.70	0.00	3.56	3.56	3.56	3.56	3.56	3.36
	2.20	3.00	3.76	3.76	3.76	3.76	3.68	3.36
	4.10	5.00	3.88	3.88	3.88	3.88	3.68	3.36
	6.00	7.00	4.00	4.00	4.00	3.88	3.68	3.36
	7.90	9.00	4.12	4.12	4.00	3.88	3.68	3.36
9.80	11.00	4.24	4.24	4.00	3.88	3.68	3.36	
11.80	13.00	4.40	4.32	4.00	3.88	3.68	3.36	
13.70	15.00	4.52	4.32	4.00	3.88	3.68	3.36	

Abbreviations:

TC: Total capacity

Notes:

1. Shaded cells indicate rating condition.

Table continued on next page ...

Table 6.2: Four-way Cassette heating capacity (continued)

Capacity (kW)	Outdoor air temperature (°C)		Indoor air temperature (°C DB)					
			16	18	20	21	22	24
			TC	TC	TC	TC	TC	TC
	WB	DB	kW	kW	kW	kW	kW	kW
4.5	-20	-19.8	2.80	2.80	2.80	2.80	2.80	2.80
	-19	-18.8	3.00	3.00	3.00	3.00	3.00	3.00
	-17	-16.7	3.15	3.15	3.15	3.15	3.15	3.15
	-15	-14.7	3.25	3.25	3.25	3.25	3.25	3.25
	-13.00	-12.60	3.35	3.35	3.35	3.35	3.35	3.35
	-11.00	-10.50	3.50	3.50	3.50	3.50	3.50	3.50
	-10.00	-9.50	3.65	3.65	3.65	3.65	3.65	3.65
	-9.10	-8.50	3.75	3.75	3.75	3.75	3.75	3.75
	-7.60	-7.00	3.80	3.80	3.80	3.80	3.80	3.80
	-5.60	-5.00	3.95	3.95	3.95	3.95	3.95	3.95
	-3.70	-3.00	4.15	4.15	4.15	4.15	4.15	4.15
	-0.70	0.00	4.45	4.45	4.45	4.45	4.45	4.20
	2.20	3.00	4.70	4.70	4.70	4.70	4.60	4.20
	4.10	5.00	4.85	4.85	4.85	4.85	4.60	4.20
	6.00	7.00	5.00	5.00	5.00	4.85	4.60	4.20
	7.90	9.00	5.15	5.15	5.00	4.85	4.60	4.20
	9.80	11.00	5.30	5.30	5.00	4.85	4.60	4.20
11.80	13.00	5.50	5.40	5.00	4.85	4.60	4.20	
13.70	15.00	5.65	5.40	5.00	4.85	4.60	4.20	
5.6	-20	-19.8	3.53	3.53	3.53	3.53	3.53	3.53
	-19	-18.8	3.78	3.78	3.78	3.78	3.78	3.78
	-17	-16.7	3.97	3.97	3.97	3.97	3.97	3.97
	-15	-14.7	4.10	4.10	4.10	4.10	4.10	4.10
	-13.00	-12.60	4.22	4.22	4.22	4.22	4.22	4.22
	-11.00	-10.50	4.41	4.41	4.41	4.41	4.41	4.41
	-10.00	-9.50	4.60	4.60	4.60	4.60	4.60	4.60
	-9.10	-8.50	4.73	4.73	4.73	4.73	4.73	4.73
	-7.60	-7.00	4.79	4.79	4.79	4.79	4.79	4.79
	-5.60	-5.00	4.98	4.98	4.98	4.98	4.98	4.98
	-3.70	-3.00	5.23	5.23	5.23	5.23	5.23	5.23
	-0.70	0.00	5.61	5.61	5.61	5.61	5.61	5.29
	2.20	3.00	5.92	5.92	5.92	5.92	5.80	5.29
	4.10	5.00	6.11	6.11	6.11	6.11	5.80	5.29
	6.00	7.00	6.30	6.30	6.30	6.11	5.80	5.29
	7.90	9.00	6.49	6.49	6.30	6.11	5.80	5.29
	9.80	11.00	6.68	6.68	6.30	6.11	5.80	5.29
11.80	13.00	6.93	6.80	6.30	6.11	5.80	5.29	
13.70	15.00	7.12	6.80	6.30	6.11	5.80	5.29	

Abbreviations:  
TC: Total capacity

Notes:  
1. Shaded cells indicate rating condition.

Table continued on next page ...

Table 6.2: Four-way Cassette heating capacity (continued)

Capacity (kW)	Outdoor air temperature (°C)		Indoor air temperature (°C DB)					
			16	18	20	21	22	24
			TC	TC	TC	TC	TC	TC
	WB	DB	kW	kW	kW	kW	kW	kW
7.1	-20	-19.8	4.48	4.48	4.48	4.48	4.48	4.48
	-19	-18.8	4.80	4.80	4.80	4.80	4.80	4.80
	-17	-16.7	5.04	5.04	5.04	5.04	5.04	5.04
	-15	-14.7	5.20	5.20	5.20	5.20	5.20	5.20
	-13.00	-12.60	5.36	5.36	5.36	5.36	5.36	5.36
	-11.00	-10.50	5.60	5.60	5.60	5.60	5.60	5.60
	-10.00	-9.50	5.84	5.84	5.84	5.84	5.84	5.84
	-9.10	-8.50	6.00	6.00	6.00	6.00	6.00	6.00
	-7.60	-7.00	6.08	6.08	6.08	6.08	6.08	6.08
	-5.60	-5.00	6.32	6.32	6.32	6.32	6.32	6.32
	-3.70	-3.00	6.64	6.64	6.64	6.64	6.64	6.64
	-0.70	0.00	7.12	7.12	7.12	7.12	7.12	6.72
	2.20	3.00	7.52	7.52	7.52	7.52	7.36	6.72
	4.10	5.00	7.76	7.76	7.76	7.76	7.36	6.72
	6.00	7.00	8.00	8.00	8.00	7.76	7.36	6.72
	7.90	9.00	8.24	8.24	8.00	7.76	7.36	6.72
	9.80	11.00	8.48	8.48	8.00	7.76	7.36	6.72
11.80	13.00	8.80	8.64	8.00	7.76	7.36	6.72	
13.70	15.00	9.04	8.64	8.00	7.76	7.36	6.72	
8.0	-20	-19.8	5.04	5.04	5.04	5.04	5.04	5.04
	-19	-18.8	5.40	5.40	5.40	5.40	5.40	5.40
	-17	-16.7	5.67	5.67	5.67	5.67	5.67	5.67
	-15	-14.7	5.85	5.85	5.85	5.85	5.85	5.85
	-13.00	-12.60	6.03	6.03	6.03	6.03	6.03	6.03
	-11.00	-10.50	6.30	6.30	6.30	6.30	6.30	6.30
	-10.00	-9.50	6.57	6.57	6.57	6.57	6.57	6.57
	-9.10	-8.50	6.75	6.75	6.75	6.75	6.75	6.75
	-7.60	-7.00	6.84	6.84	6.84	6.84	6.84	6.84
	-5.60	-5.00	7.11	7.11	7.11	7.11	7.11	7.11
	-3.70	-3.00	7.47	7.47	7.47	7.47	7.47	7.47
	-0.70	0.00	8.01	8.01	8.01	8.01	8.01	7.56
	2.20	3.00	8.46	8.46	8.46	8.46	8.28	7.56
	4.10	5.00	8.73	8.73	8.73	8.73	8.28	7.56
	6.00	7.00	9.00	9.00	9.00	8.73	8.28	7.56
	7.90	9.00	9.27	9.27	9.00	8.73	8.28	7.56
	9.80	11.00	9.54	9.54	9.00	8.73	8.28	7.56
11.80	13.00	9.90	9.72	9.00	8.73	8.28	7.56	
13.70	15.00	10.17	9.72	9.00	8.73	8.28	7.56	

Abbreviations:  
TC: Total capacity

Notes:  
1. Shaded cells indicate rating condition.

Table continued on next page ...

Table 6.2: Four-way Cassette heating capacity (continued)

Capacity (kW)	Outdoor air temperature (°C)		Indoor air temperature (°C DB)					
			16	18	20	21	22	24
			TC	TC	TC	TC	TC	TC
	WB	DB	kW	kW	kW	kW	kW	kW
9.0	-20	-19.8	5.60	5.04	5.60	5.60	5.60	5.60
	-19	-18.8	6.00	5.40	6.00	6.00	6.00	6.00
	-17	-16.7	6.30	6.30	6.30	6.30	6.30	6.30
	-15	-14.7	6.50	6.50	6.50	6.50	6.50	6.50
	-13.00	-12.60	6.70	6.70	6.70	6.70	6.70	6.70
	-11.00	-10.50	7.00	7.00	7.00	7.00	7.00	7.00
	-10.00	-9.50	7.30	7.30	7.30	7.30	7.30	7.30
	-9.10	-8.50	7.50	7.50	7.50	7.50	7.50	7.50
	-7.60	-7.00	7.60	7.60	7.60	7.60	7.60	7.60
	-5.60	-5.00	7.90	7.90	7.90	7.90	7.90	7.90
	-3.70	-3.00	8.30	8.30	8.30	8.30	8.30	8.30
	-0.70	0.00	8.90	8.90	8.90	8.90	8.90	8.40
	2.20	3.00	9.40	9.40	9.40	9.40	9.20	8.40
	4.10	5.00	9.70	9.70	9.70	9.70	9.20	8.40
	6.00	7.00	10.00	10.00	10.00	9.70	9.20	8.40
	7.90	9.00	10.30	10.30	10.00	9.70	9.20	8.40
9.80	11.00	10.60	10.60	10.00	9.70	9.20	8.40	
11.80	13.00	11.00	10.80	10.00	9.70	9.20	8.40	
13.70	15.00	11.30	10.80	10.00	9.70	9.20	8.40	
10.0	-20	-19.8	6.16	6.16	6.16	6.16	6.16	6.16
	-19	-18.8	6.60	6.60	6.60	6.60	6.60	6.60
	-17	-16.7	6.93	6.93	6.93	6.93	6.93	6.93
	-15	-14.7	7.15	7.15	7.15	7.15	7.15	7.15
	-13.00	-12.60	7.37	7.37	7.37	7.37	7.37	7.37
	-11.00	-10.50	7.70	7.70	7.70	7.70	7.70	7.70
	-10.00	-9.50	8.03	8.03	8.03	8.03	8.03	8.03
	-9.10	-8.50	8.25	8.25	8.25	8.25	8.25	8.25
	-7.60	-7.00	8.36	8.36	8.36	8.36	8.36	8.36
	-5.60	-5.00	8.69	8.69	8.69	8.69	8.69	8.69
	-3.70	-3.00	9.13	9.13	9.13	9.13	9.13	9.13
	-0.70	0.00	9.79	9.79	9.79	9.79	9.79	9.24
	2.20	3.00	10.34	10.34	10.34	10.34	10.12	9.24
	4.10	5.00	10.67	10.67	10.67	10.67	10.12	9.24
	6.00	7.00	11.00	11.00	11.00	10.67	10.12	9.24
	7.90	9.00	11.33	11.33	11.00	10.67	10.12	9.24
9.80	11.00	11.66	11.66	11.00	10.67	10.12	9.24	
11.80	13.00	12.10	11.88	11.00	10.67	10.12	9.24	
13.70	15.00	12.43	11.88	11.00	10.67	10.12	9.24	

Abbreviations:  
TC: Total capacity

Notes:  
1. Shaded cells indicate rating condition.

Table continued on next page ...

Table 6.2: Four-way Cassette heating capacity (continued)

Capacity (kW)	Outdoor air temperature (°C)		Indoor air temperature (°C DB)					
			16	18	20	21	22	24
			TC	TC	TC	TC	TC	TC
	WB	DB	kW	kW	kW	kW	kW	kW
1.2	-20	-19.8	7.00	7.00	7.00	7.00	7.00	7.00
	-19	-18.8	7.50	7.50	7.50	7.50	7.50	7.50
	-17	-16.7	7.88	7.88	7.88	7.88	7.88	7.88
	-15	-14.7	8.13	8.13	8.13	8.13	8.13	8.13
	-13.00	-12.60	8.38	8.38	8.38	8.38	8.38	8.38
	-11.00	-10.50	8.75	8.75	8.75	8.75	8.75	8.75
	-10.00	-9.50	9.13	9.13	9.13	9.13	9.13	9.13
	-9.10	-8.50	9.38	9.38	9.38	9.38	9.38	9.38
	-7.60	-7.00	9.50	9.50	9.50	9.50	9.50	9.50
	-5.60	-5.00	9.88	9.88	9.88	9.88	9.88	9.88
	-3.70	-3.00	10.38	10.38	10.38	10.38	10.38	10.38
	-0.70	0.00	11.13	11.13	11.13	11.13	11.13	10.50
	2.20	3.00	11.75	11.75	11.75	11.75	11.50	10.50
	4.10	5.00	12.13	12.13	12.13	12.13	11.50	10.50
	6.00	7.00	12.50	12.50	12.50	12.13	11.50	10.50
	7.90	9.00	12.88	12.88	12.50	12.13	11.50	10.50
	9.80	11.00	13.25	13.25	12.50	12.13	11.50	10.50
11.80	13.00	13.75	13.50	12.50	12.13	11.50	10.50	
13.70	15.00	14.13	13.50	12.50	12.13	11.50	10.50	
14.0	-20	-19.8	8.96	8.96	8.96	8.96	8.96	8.96
	-19	-18.8	9.60	9.60	9.60	9.60	9.60	9.60
	-17	-16.7	10.08	10.08	10.08	10.08	10.08	10.08
	-15	-14.7	10.40	10.40	10.40	10.40	10.40	10.40
	-13.00	-12.60	11.04	11.04	11.04	11.04	11.04	11.04
	-11.00	-10.50	11.20	11.36	11.36	11.36	11.36	11.36
	-10.00	-9.50	11.68	11.68	11.68	11.68	11.68	11.68
	-9.10	-8.50	12.00	12.00	12.00	12.00	12.00	12.00
	-7.60	-7.00	12.16	12.16	12.16	12.16	12.16	12.16
	-5.60	-5.00	12.64	12.64	12.64	12.64	12.64	12.64
	-3.70	-3.00	13.28	13.28	13.28	13.28	13.28	13.28
	-0.70	0.00	14.24	14.24	14.24	14.24	14.24	13.44
	2.20	3.00	15.04	15.04	15.04	15.04	14.72	13.44
	4.10	5.00	15.52	15.52	15.52	15.52	14.72	13.44
	6.00	7.00	16.00	16.00	16.00	15.52	14.72	13.44
	7.90	9.00	16.48	16.48	16.00	15.52	14.72	13.44
	9.80	11.00	16.96	16.96	16.00	15.52	14.72	13.44
11.80	13.00	17.60	17.28	16.00	15.52	14.72	13.44	
13.70	15.00	18.08	17.28	16.00	15.52	14.72	13.44	

Abbreviations:  
TC: Total capacity

Notes:  
1. Shaded cells indicate rating condition.

## 7 Electrical Characteristics

Table 7.1: Four-way Cassette electrical characteristics

Model name	Power supply						Indoor fan motors	
	Hz	Volts	Min. volts	Max. volts	MCA	MFA	Rated motor output (kW)	FLA
SDV5-56CA	50	220-240	198	264	0.56	15	0.08	0.45
SDV5-71CA	50	220-240	198	264	0.56	15	0.08	0.45
SDV5-80CA	50	220-240	198	264	0.76	15	0.08	0.61
SDV5-90CA	50	220-240	198	264	0.88	15	0.17	0.70
SDV5-100CA	50	220-240	198	264	1.00	15	0.17	0.80
SDV5-112CA	50	220-240	198	264	1.00	15	0.17	0.80
SDV5-140CA	50	220-240	198	264	1.20	15	0.17	0.96

Abbreviations:

MCA: Minimum Circuit Amps

MFA: Maximum Fuse Amps

FLA: Full Load Amps



## 8 Sound Levels

### 8.1 Overall

Table 8.1: Four-way Cassette sound pressure levels<sup>1</sup>

Model name	Sound pressure levels dB(A)						
	SSH	SH	H	M	L	SL	SSL
SDV5-56CA	43	41	39	38	36	35	34
SDV5-71CA	45	43	41	39	37	35	34
SDV5-80CA	46	44	42	40	38	36	35
SDV5-90CA	47	45	43	41	39	37	36
SDV5-100CA	47	45	43	41	39	37	36
SDV5-112CA	47	45	43	41	39	37	36
SDV5-140CA	50	48	46	45	38	36	35

Notes:

1. Sound pressure levels are measured 1.4m below the unit in a semi-anechoic chamber. During in-situ operation, sound pressure levels may be higher as a result of ambient noise.

Figure 8.1: Four-way Cassette sound pressure level measurement

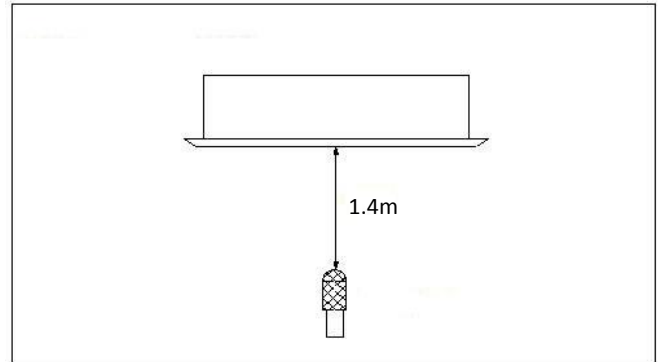

### 8.2 Octave Band Levels

Figure 8.3: SDV5-56CA octave band levels

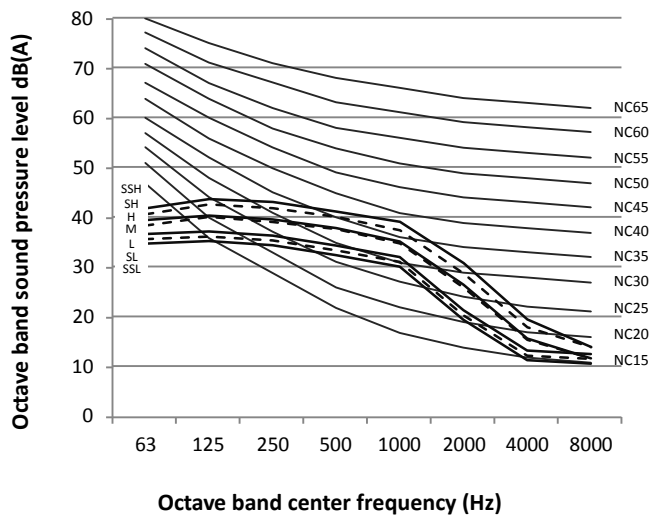

Figure 8.4: SDV5-71CA octave band levels

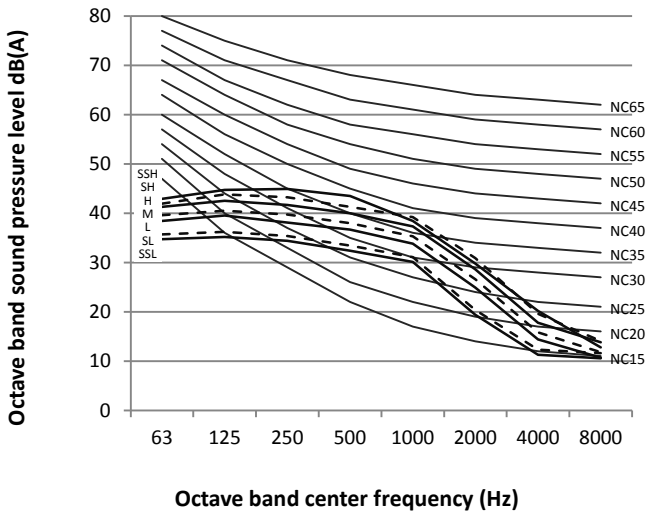

Figure 8.5: SDV5-80CA octave band levels

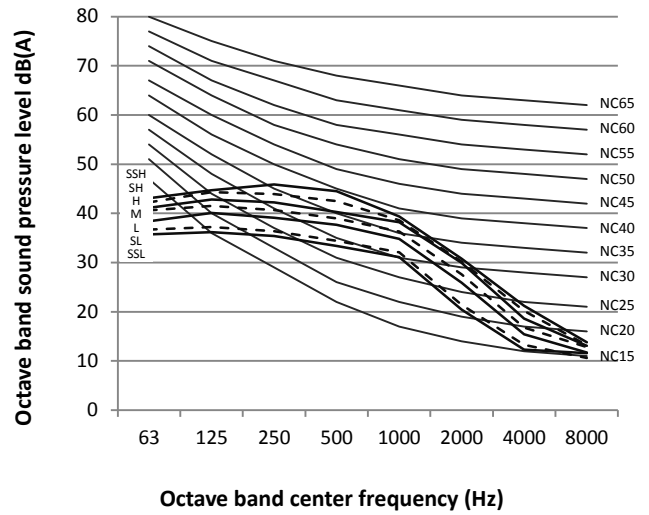

Figure 8.6: SDV5-90,100,112CA octave band levels

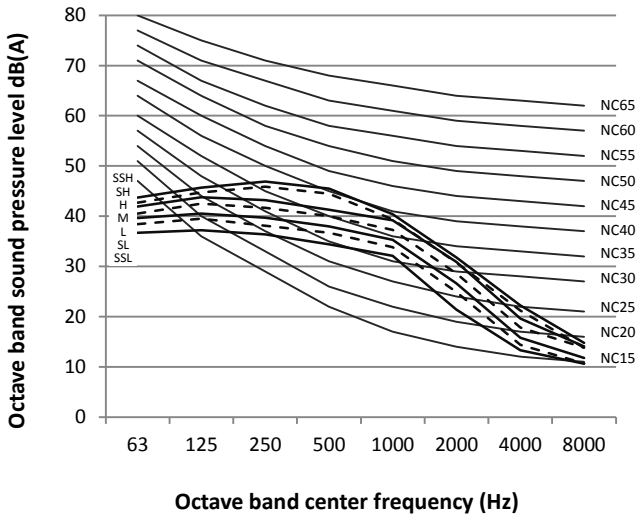
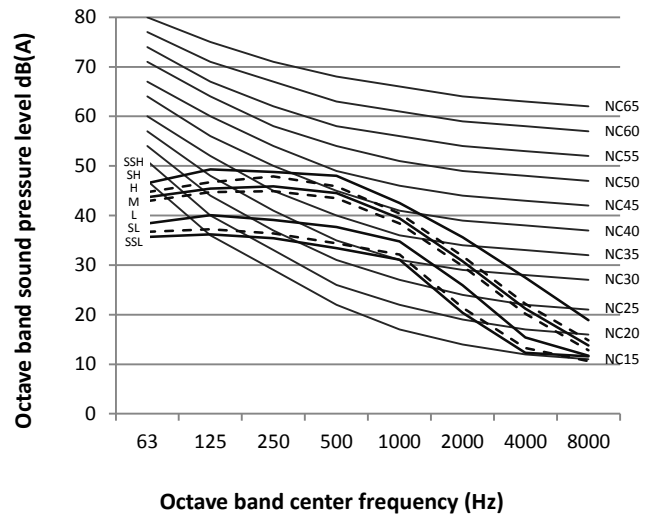
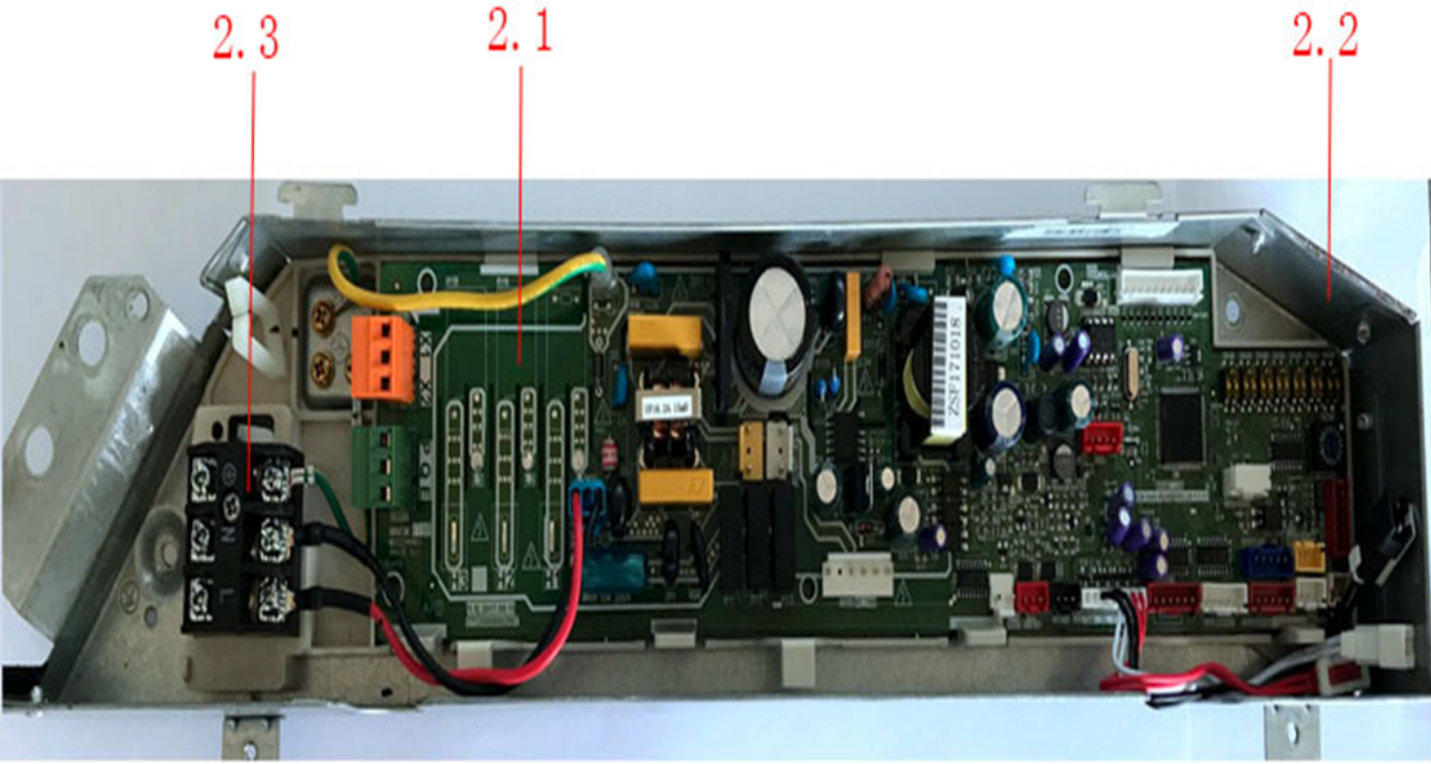
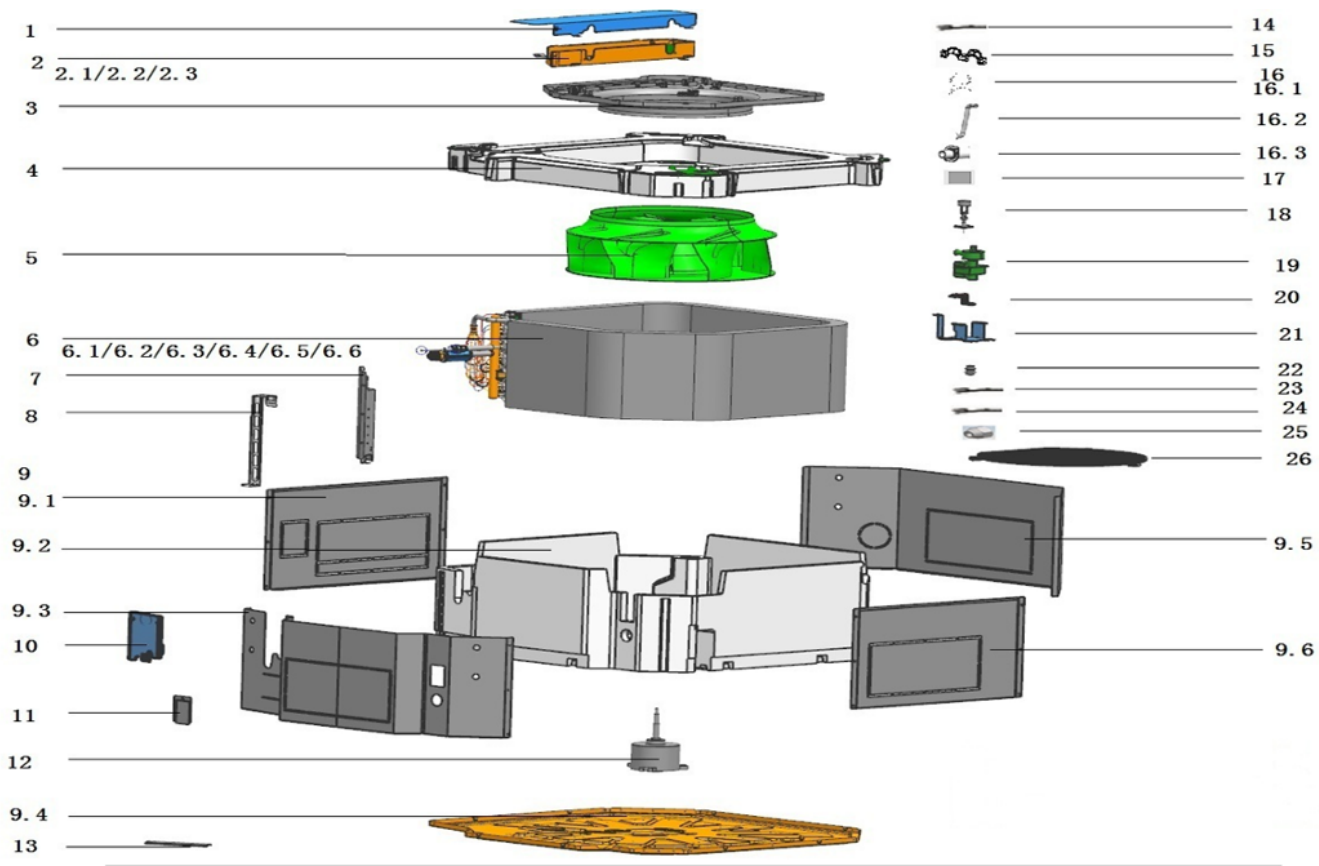

Figure 8.7: SDV5-140CA octave band levels



# Exploded View

SDV5-56-112CA





# FULL DC INVERTER SYSTEMS

## PARTS GUIDE

FOUR-WAY CASSETTE UNITS SDV5-56-140CA

COMMERCIAL AIR CONDITIONERS SDV5

SDV5-56CA

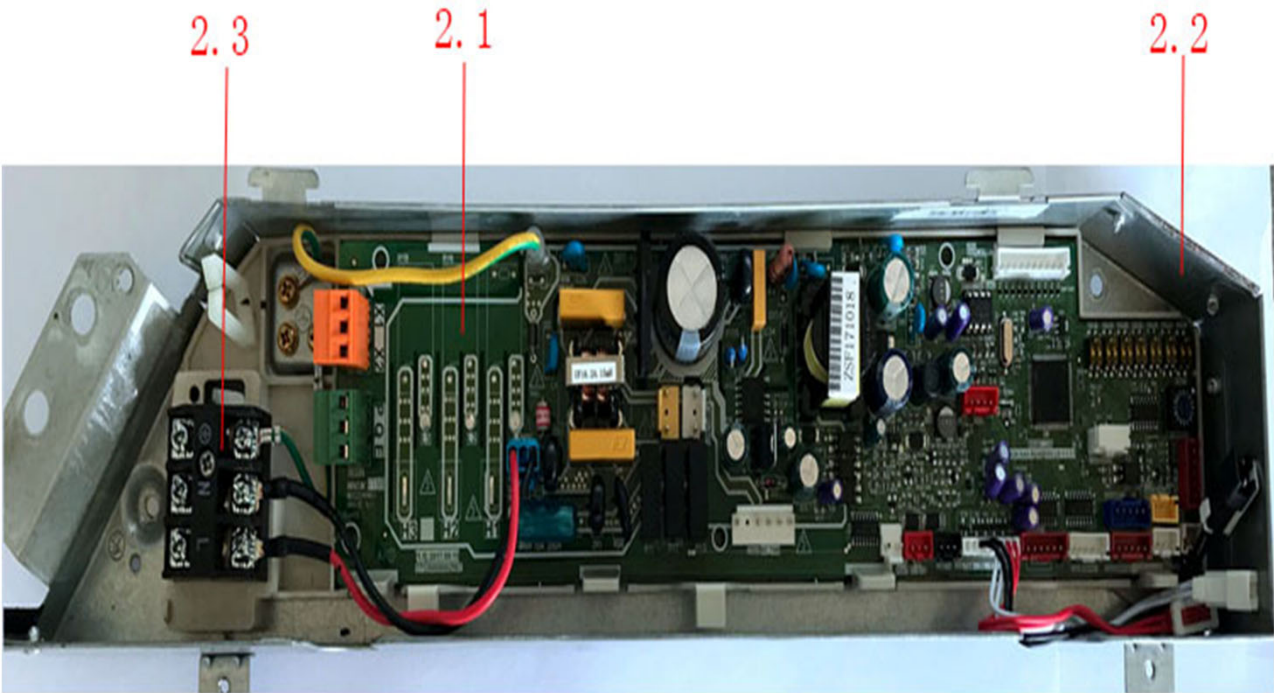
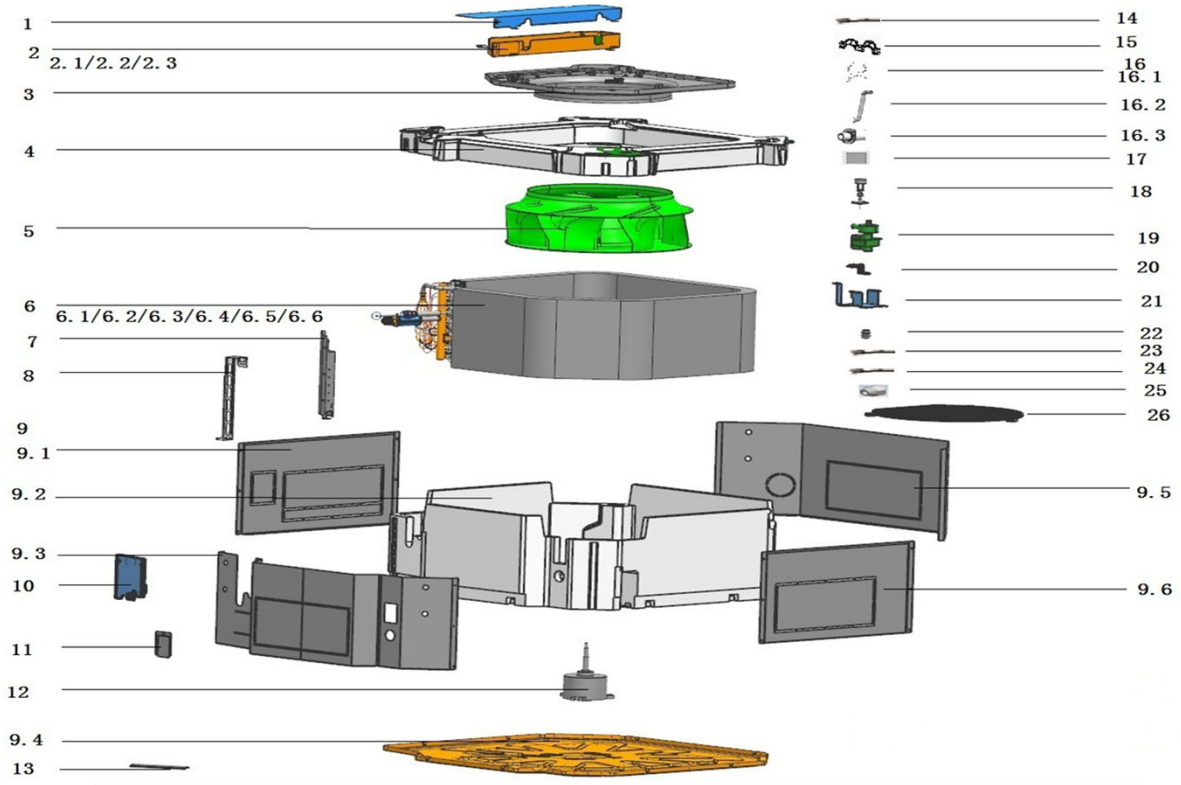

No	Description	Part Code	Note	Qty	Price Code
<b>MODEL: SDV5-56CA CASSETTE FOUR-WAY UNIT</b>					
1	E-part box cover ass'y	12226000000127		1	
2	E-part box assembly	172260000002639		1	
2.1	Indoor unit main control board	171260000003315		1	
2.2	E-part box ass'y	12226000000128		1	
2.3	Wire terminal	17400401000189		1	
3	Ring ass'y	12126000000114		1	
4	Foam parts water tray	12826000000020		1	
5	centrifuge fan	12100103000149		1	
6	Evaporator assembly	158260000002236		1	
6.1	Evaporator	15826000000209		1	
6.2	Evaporator input pipe ass'y	15426000000171		1	
6.3	Evaporator output pipe ass'y	151260000001334		1	
6.6	Pipe temperature sensor assemblies	11201007003024		1	
7	Evaporator connection board	12226000000118		1	
8	Evaporator fixing hanger	12226000000112		2	
9	Chassis assembly	122260000003754		1	
9.1	Board ass'y	122260000000091		1	
9.2	Foam	128260000000018		1	
9.3	Board ass'y	122260000000094		1	
9.4	Base ass'y	122225000000952		1	
9.5	Board ass'y	122260000000093		1	
9.6	Board ass'y	122260000000092		1	
10	Sealed board ass'y	121260000000332		1	
11	Cover subassembly	122225000000067		1	
12	Brushless DC Motor	11002015002001		1	
13	Clip	122002030000041		1	
14	Room Temperature Sensor	11201007003044		1	
15	Clip	122002030000041		1	
16	drain pipe ass'y	126260000000011		1	
16.1	Spring	122225000000376		1	
16.2	Water pipe	121005090000068		1	
16.3	Drainpipe	126260000000009		1	
17	Fan clip	122225000000126		1	
18	Water level switch	174005110000039		1	
19	Drain pump	17400802001113		1	
20	Bracket of water level sensor	121260000000043		1	
21	Water Pump installation bracket ass'y	122260000000115		1	
22	Rubber washer	12600401001935		3	
23	Weak electric cable group	17401204009025		1	
24	Ground wire	17401108000193		1	
25	Copper nut	15500406000010		1	
25	Copper nut	155004060000003		1	
26	Fan fence	121260000000041		1	

**The data are subject to change without notice.**

SDV5-71CA

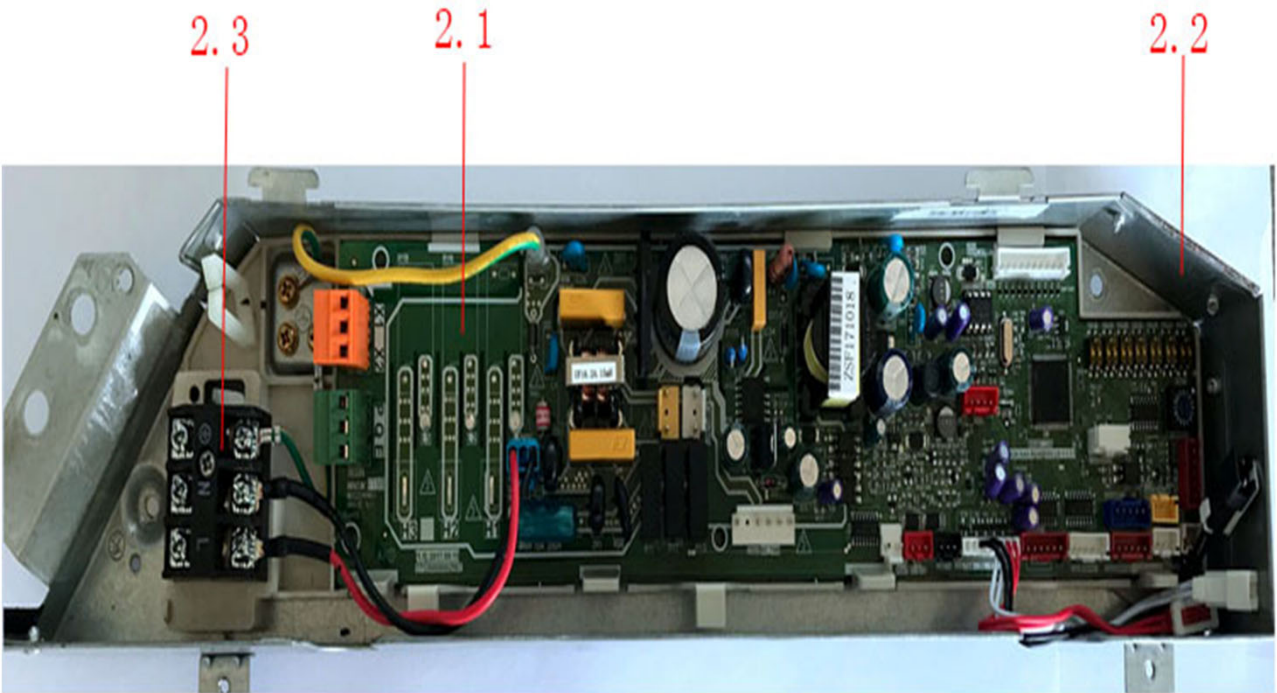
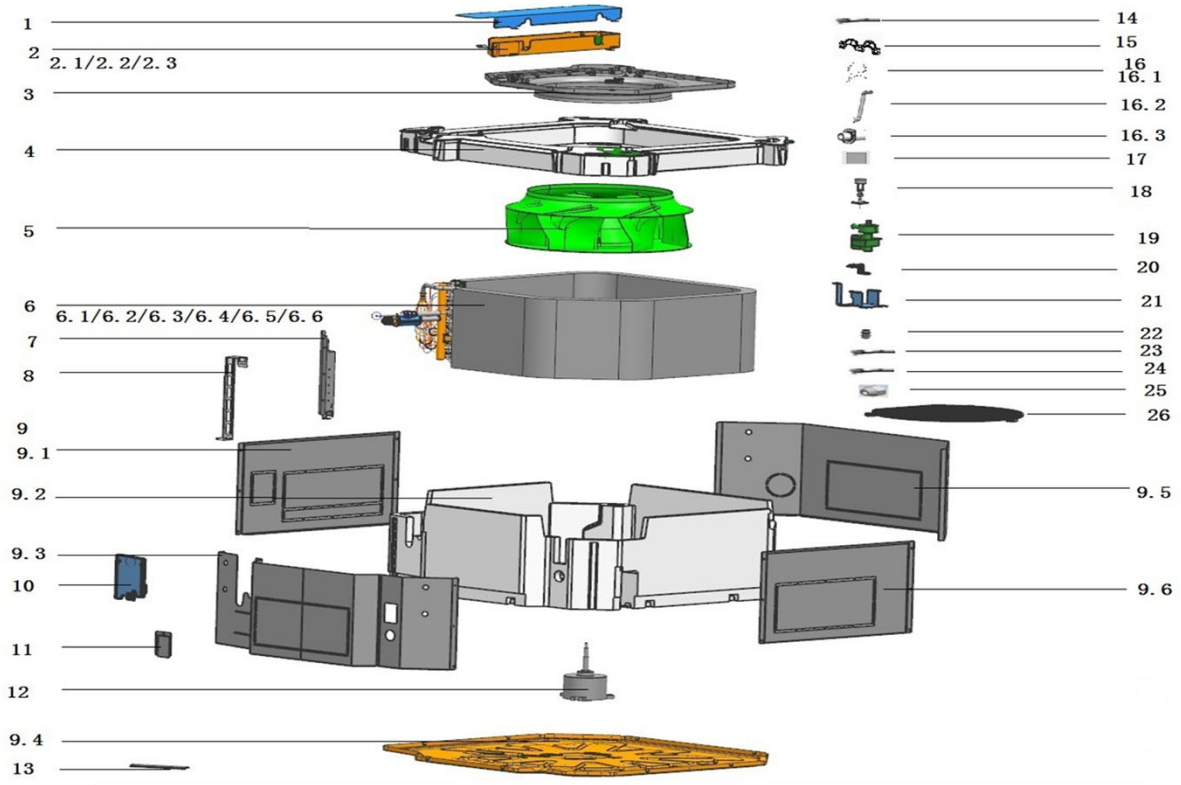

No	Description	Part Code	Note	Qty	Price Code
<b>MODEL: SDV5-71CA CASSETTE FOUR-WAY UNIT</b>					
1	E-part box cover ass'y	12226000000127		1	
2	E-part box assembly	172260000002639		1	
2.1	Indoor unit main control board	171260000003315		1	
2.2	E-part box ass'y	12226000000128		1	
2.3	Wire terminal	17400401000189		1	
3	Ring ass'y	12126000000114		1	
4	Foam parts water tray	12826000000020		1	
5	centrifuge fan	12100103000149		1	
6	Evaporator assembly	158260000002236		1	
6.1	Evaporator	15826000000209		1	
6.2	Evaporator input pipe ass'y	15426000000171		1	
6.3	Evaporator output pipe ass'y	151260000001334		1	
6.6	Pipe temperature sensor assemblies	11201007003024		1	
7	Evaporator connection board	12226000000118		1	
8	Evaporator fixing hanger	12226000000112		2	
9	Chassis assembly	122260000003754		1	
9.1	Board ass'y	122260000000091		1	
9.2	Foam	12826000000018		1	
9.3	Board ass'y	122260000000094		1	
9.4	Base ass'y	122225000000952		1	
9.5	Board ass'y	122260000000093		1	
9.6	Board ass'y	122260000000092		1	
10	Sealed board ass'y	121260000000332		1	
11	Cover subassembly	122225000000067		1	
12	Brushless DC Motor	11002015002001		1	
13	Clip	12200203000041		1	
14	Room Temperature Sensor	11201007003044		1	
15	Clip	12200203000041		1	
16	drain pipe ass'y	12626000000011		1	
16.1	Spring	122225000000376		1	
16.2	Water pipe	12100509000068		1	
16.3	Drainpipe	12626000000009		1	
17	Fan clip	122225000000126		1	
18	Water level switch	17400511000039		1	
19	Drain pump	17400802001113		1	
20	Bracket of water level sensor	121260000000043		1	
21	Water Pump installation bracket ass'y	122260000000115		1	
22	Rubber washer	12600401001935		3	
23	Weak electric cable group	17401204009025		1	
24	Ground wire	17401108000193		1	
25	Copper nut	15500406000010		1	
25	Copper nut	15500406000003		1	
26	Fan fence	121260000000041		1	

**The data are subject to change without notice.**



SDV5-80CA

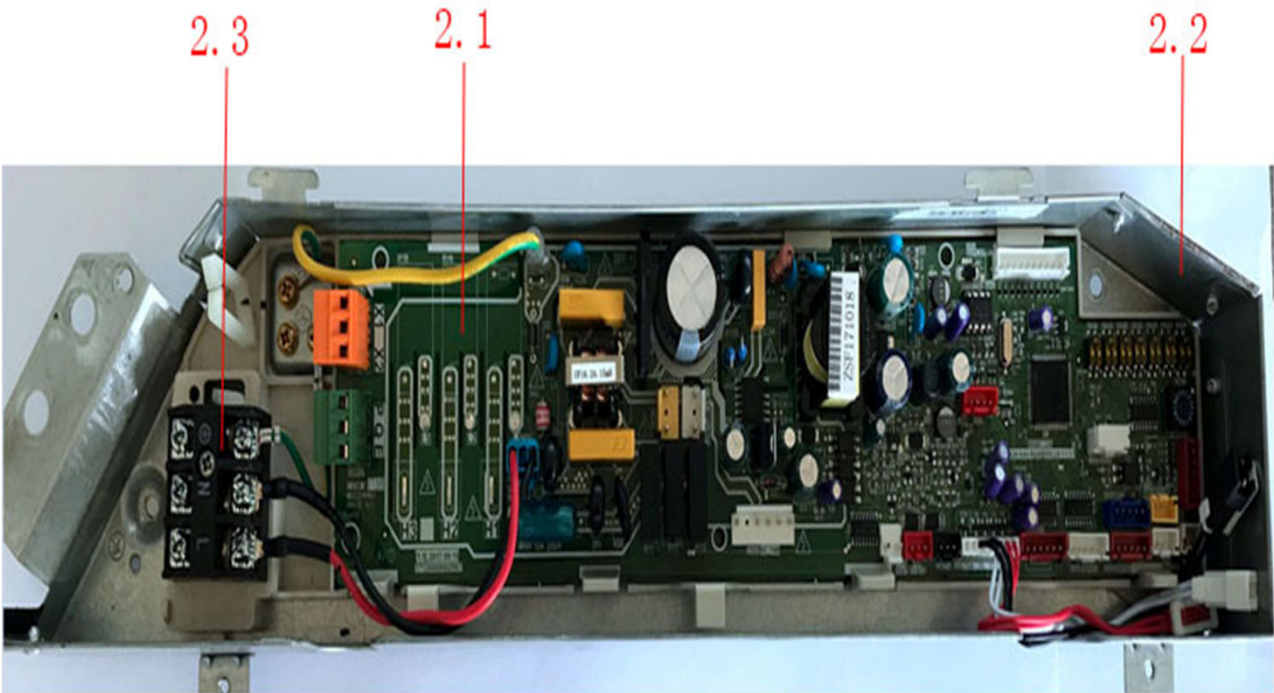
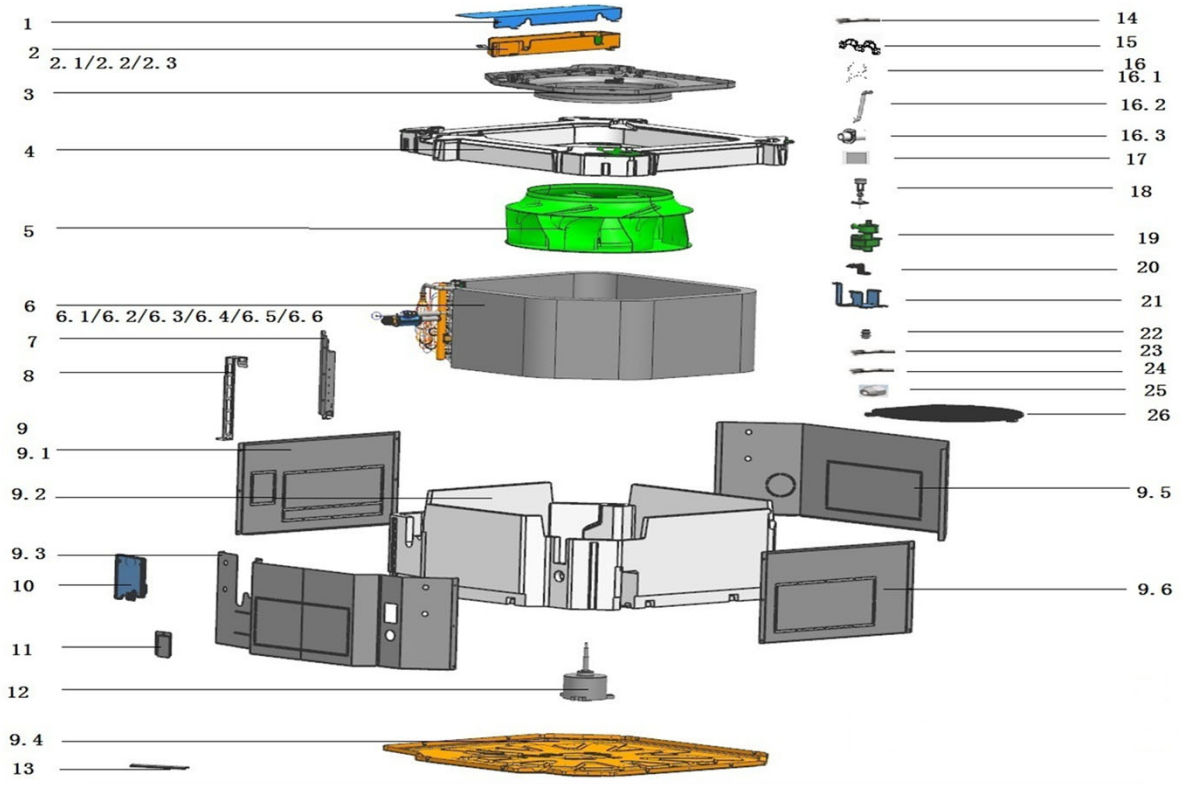

No	Description	Part Code	Note	Qty	Price Code
<b>MODEL: SDV5-80CA CASSETTE FOUR-WAY UNIT</b>					
1	E-part box cover ass'y	12226000000127		1	
2	E-part box assembly	172260000002639		1	
2.1	Indoor unit main control board	171260000003315		1	
2.2	E-part box ass'y	12226000000128		1	
2.3	Wire terminal	17400401000189		1	
3	Ring ass'y	12126000000114		1	
4	Foam parts water tray	12826000000020		1	
5	centrifuge fan	12100103000149		1	
6	Evaporator assembly	158260000002236		1	
6.1	Evaporator	15826000000209		1	
6.2	Evaporator input pipe ass'y	15426000000171		1	
6.3	Evaporator output pipe ass'y	151260000001334		1	
6.6	Pipe temperature sensor assemblies	11201007003024		1	
7	Evaporator connection board	12226000000118		1	
8	Evaporator fixing hanger	12226000000112		2	
9	Chassis assembly	122260000003754		1	
9.1	Board ass'y	122260000000091		1	
9.2	Foam	128260000000018		1	
9.3	Board ass'y	122260000000094		1	
9.4	Base ass'y	122225000000952		1	
9.5	Board ass'y	122260000000093		1	
9.6	Board ass'y	122260000000092		1	
10	Sealed board ass'y	121260000000332		1	
11	Cover subassembly	122225000000067		1	
12	Brushless DC Motor	11002015002001		1	
13	Clip	122002030000041		1	
14	Room Temperature Sensor	11201007003044		1	
15	Clip	122002030000041		1	
16	drain pipe ass'y	126260000000011		1	
16.1	Spring	122225000000376		1	
16.2	Water pipe	121005090000068		1	
16.3	Drainpipe	126260000000009		1	
17	Fan clip	122225000000126		1	
18	Water level switch	174005110000039		1	
19	Drain pump	17400802001113		1	
20	Bracket of water level sensor	121260000000043		1	
21	Water Pump installation bracket ass'y	122260000000115		1	
22	Rubber washer	12600401001935		3	
23	Weak electric cable group	17401204009025		1	
24	Ground wire	17401108000193		1	
25	Copper nut	155004060000003		1	
25	Copper nut	155004060000010		1	
26	Fan fence	121260000000041		1	

**The data are subject to change without notice.**

SDV5-90CA

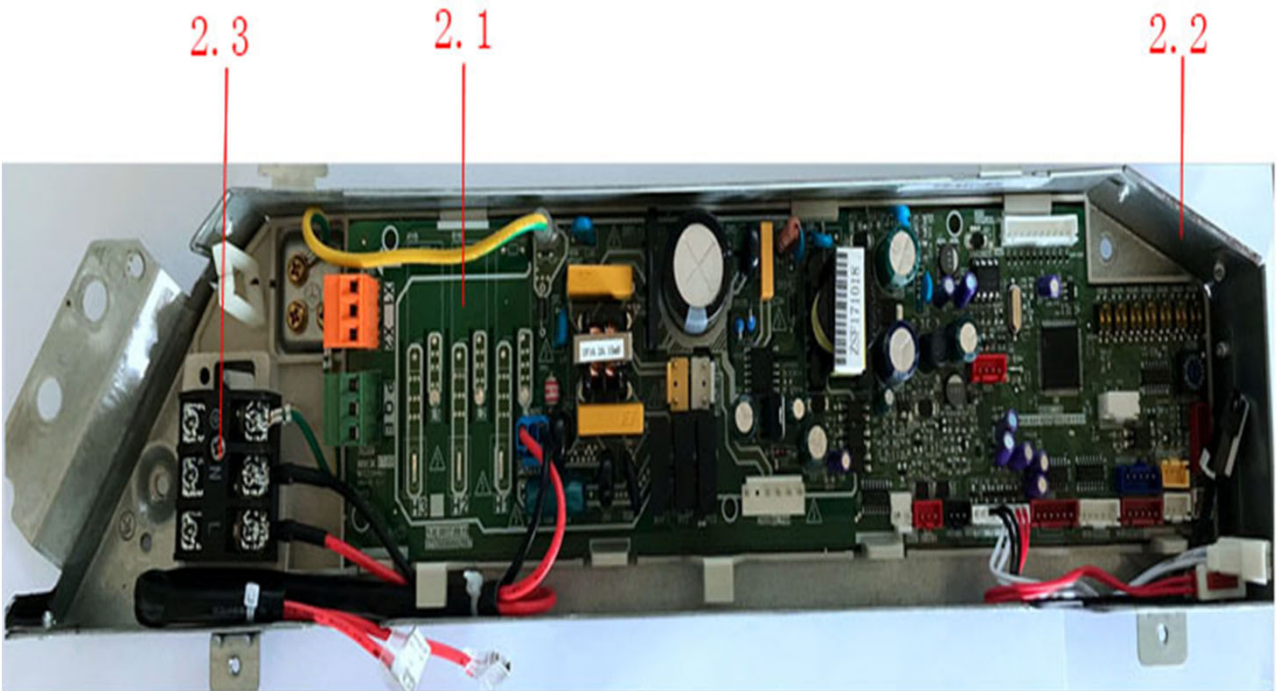
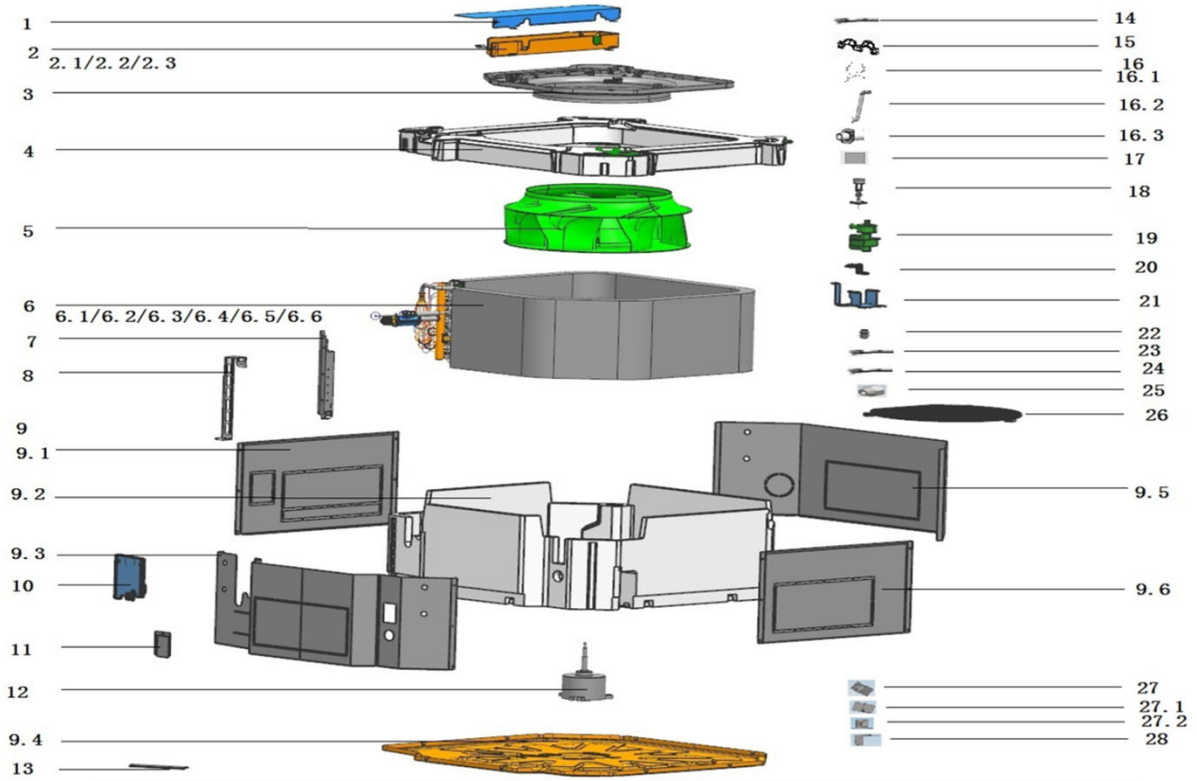

No	Description	Part Code	Note	Qty	Price Code
<b>MODEL: SDV5-90CA CASSETTE FOUR-WAY UNIT</b>					
1	E-part box cover ass'y	12226000000127		1	
2	E-part box assembly	17226000002638		1	
2.1	Indoor unit main control board	17126000003315		1	
2.2	E-part box ass'y	12226000000128		1	
2.3	Wire terminal	17400401000189		1	
3	Ring ass'y	12126000000114		1	
4	Foam parts water tray	12826000000007		1	
5	centrifuge fan	12100103000142		1	
6	Evaporator assembly	15826000002233		1	
6.1	Evaporator	15826000000216		1	
6.2	Evaporator input pipe ass'y	15426000000165		1	
6.3	Evaporator output pipe ass'y	15126000001327		1	
6.6	Pipe temperature sensor assemblies	11201007003024		1	
7	Evaporator connection board	12226000000121		1	
8	Evaporator fixing hanger	12226000000107		2	
9	Chassis assembly	12226000003753		1	
9.1	Board II ass'y	12226000000095		1	
9.2	Foam	12826000000014		1	
9.4	Bass ass'y	12226000000506		1	
9.5	Coaming assembly	12226000000106		1	
9.6	Board ass'y	12226000000090		1	
10	Sealed board ass'y	12126000000332		1	
11	Cover subassembly	12225000000067		1	
12	Brushless DC Motor	11002015002002		1	
13	Clip	12200203000041		1	
14	Room Temperature Sensor	11201007003044		1	
15	Clip	12200203000041		1	
16	drain pipe ass'y	12626000000010		1	
16.1	Spring	12225000000376		1	
16.2	Water pipe	12100509000068		1	
16.3	Drainpipe	12626000000008		1	
17	Fan clip	12225000000126		1	
18	Water level switch	17400511000039		1	
19	Drain pump	17400802001113		1	
20	Bracket of water level sensor	12126000000043		1	
21	Water Pump installation bracket ass'y	12226000000115		1	
22	Rubber washer	12600401001935		3	
23	Weak electric cable group	17401204009025		1	
24	Ground wire	17401108000217		1	
24	Ground wire	17401108000193		1	
25	Copper nut	15500406000010		1	
25	Copper nut	15500406000003		1	
26	Fan fence	12126000000041		1	
28	Support	12226000003733		1	

**The data are subject to change without notice.**

SDV5-100CA

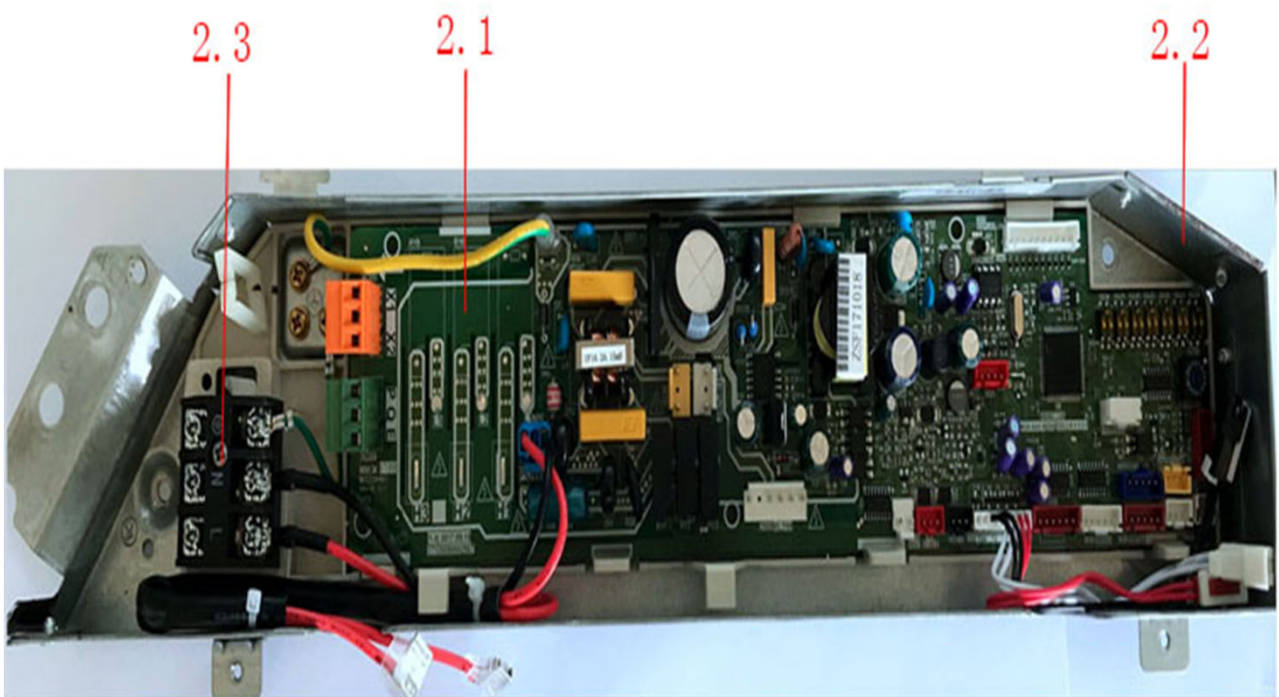
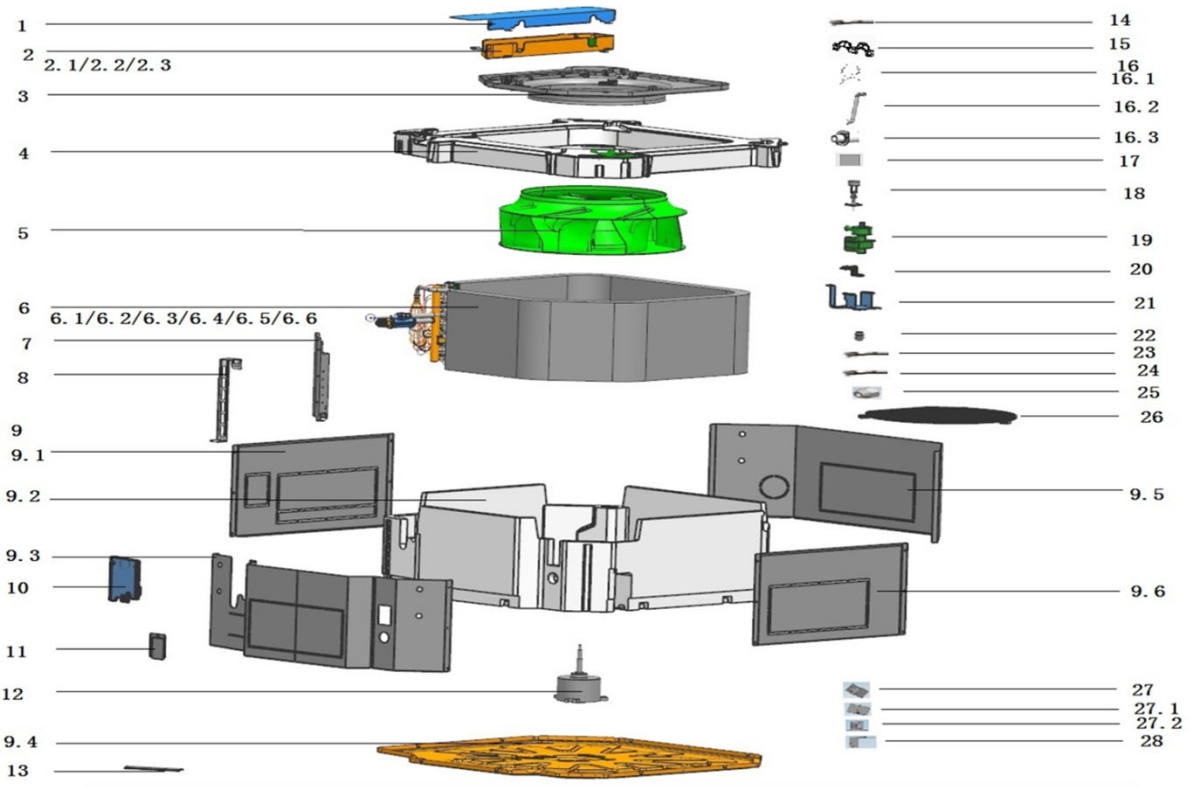

No	Description	Part Code	Note	Qty	Price Code
<b>MODEL: SDV5-100CA CASSETTE FOUR-WAY UNIT</b>					
1	E-part box cover ass'y	12226000000127		1	
2	E-part box assembly	17226000002638		1	
2.1	Indoor unit main control board	17126000003315		1	
2.2	E-part box ass'y	12226000000128		1	
2.3	Wire terminal	17400401000189		1	
3	Ring ass'y	12126000000114		1	
4	Foam parts water tray	12826000000007		1	
5	centrifuge fan	12100103000142		1	
6	Evaporator assembly	15826000002233		1	
6.1	Evaporator	15826000000216		1	
6.2	Evaporator input pipe ass'y	15426000000165		1	
6.3	Evaporator output pipe ass'y	15126000001327		1	
6.6	Pipe temperature sensor assemblies	11201007003024		1	
7	Evaporator connection board	12226000000121		1	
8	Evaporator fixing hanger	12226000000107		2	
9	Chassis assembly	12226000003753		1	
9.1	Board II ass'y	12226000000095		1	
9.2	Foam	12826000000014		1	
9.4	Bass ass'y	12226000000506		1	
9.5	Coaming assembly	12226000000106		1	
9.6	Board ass'y	12226000000090		1	
10	Sealed board ass'y	12126000000332		1	
11	Cover subassembly	12225000000067		1	
12	Brushless DC Motor	11002015002002		1	
13	Clip	12200203000041		1	
14	Room Temperature Sensor	11201007003044		1	
15	Clip	12200203000041		1	
16	drain pipe ass'y	12626000000010		1	
16.1	Spring	12225000000376		1	
16.2	Water pipe	12100509000068		1	
16.3	Drainpipe	12626000000008		1	
17	Fan clip	12225000000126		1	
18	Water level switch	17400511000039		1	
19	Drain pump	17400802001113		1	
20	Bracket of water level sensor	12126000000043		1	
21	Water Pump installation bracket ass'y	12226000000115		1	
22	Rubber washer	12600401001935		3	
23	Weak electric cable group	17401204009025		1	
24	Ground wire	17401108000217		1	
24	Ground wire	17401108000193		1	
25	Copper nut	15500406000003		1	
25	Copper nut	15500406000010		1	
26	Fan fence	12126000000041		1	
28	Support	12226000003733		1	

**The data are subject to change without notice.**

SDV5-112CA

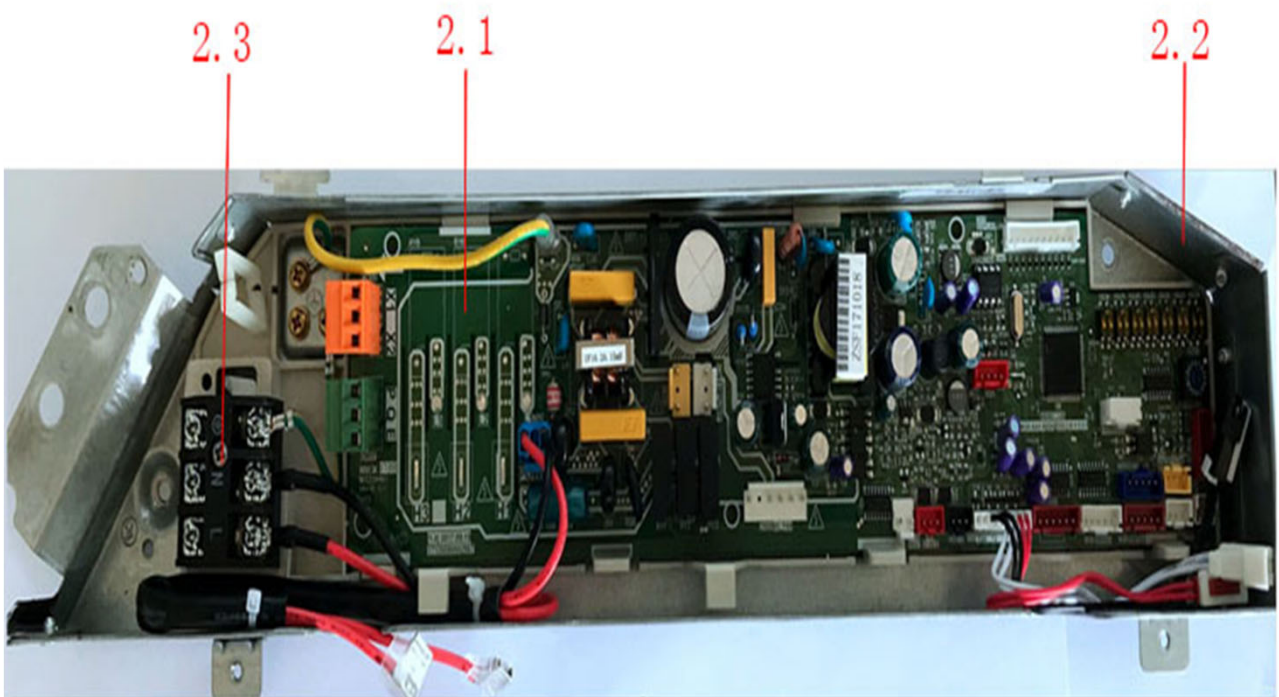
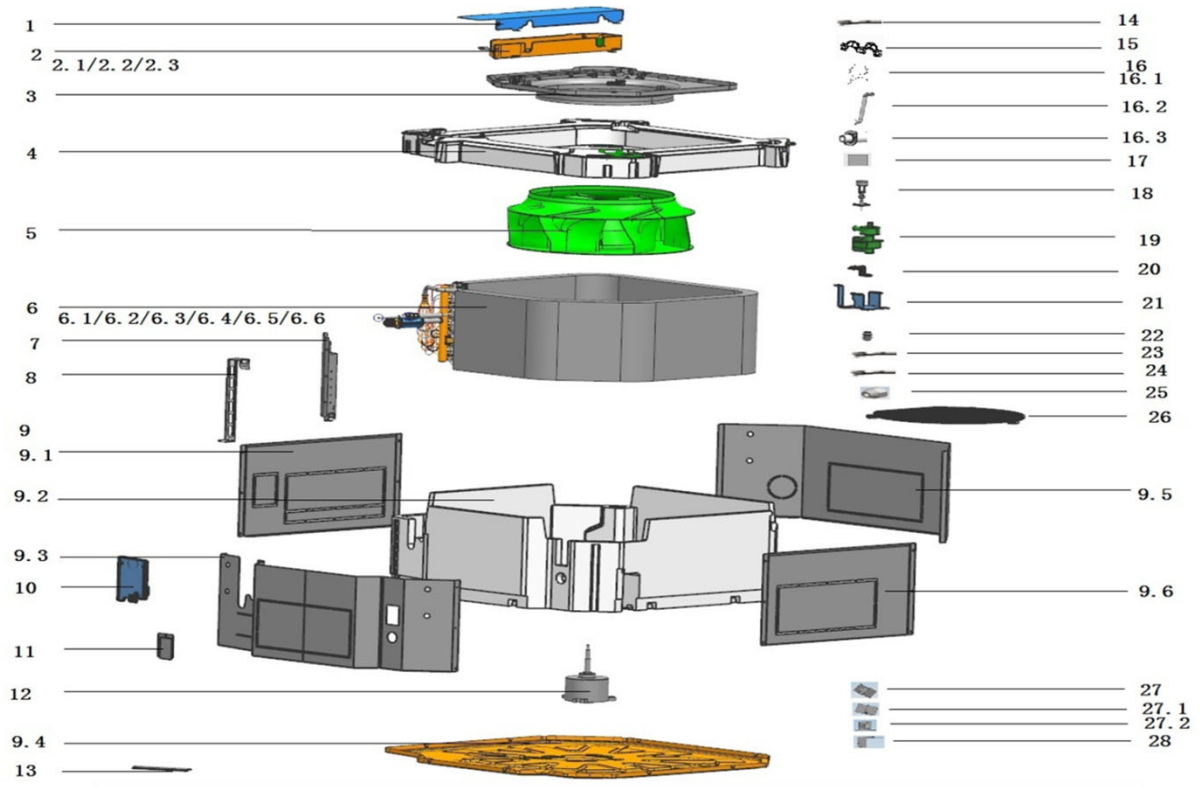

No	Description	Part Code	Note	Qty	Price Code
<b>MODEL: SDV5-112CA CASSETTE FOUR-WAY UNIT</b>					
1	E-part box cover ass'y	12226000000127		1	
2	E-part box assembly	17226000002638		1	
2.1	Indoor unit main control board	17126000003315		1	
2.2	E-part box ass'y	12226000000128		1	
2.3	Wire terminal	17400401000189		1	
3	Ring ass'y	12126000000114		1	
4	Foam parts water tray	12826000000007		1	
5	centrifuge fan	12100103000142		1	
6	Evaporator assembly	15826000002233		1	
6.1	Evaporator	15826000000216		1	
6.2	Evaporator input pipe ass'y	15426000000165		1	
6.3	Evaporator output pipe ass'y	15126000001327		1	
6.6	Pipe temperature sensor assemblies	11201007003024		1	
7	Evaporator connection board	12226000000121		1	
8	Evaporator fixing hanger	12226000000107		2	
9	Chassis assembly	12226000003753		1	
9.1	Board II ass'y	12226000000095		1	
9.2	Foam	12826000000014		1	
9.4	Bass ass'y	12226000000506		1	
9.5	Coaming assembly	12226000000106		1	
9.6	Board ass'y	12226000000090		1	
10	Sealed board ass'y	12126000000332		1	
11	Cover subassembly	12225000000067		1	
12	Brushless DC Motor	11002015002002		1	
13	Clip	12200203000041		1	
14	Room Temperature Sensor	11201007003044		1	
15	Clip	12200203000041		1	
16	drain pipe ass'y	12626000000010		1	
16.1	Spring	12225000000376		1	
16.2	Water pipe	12100509000068		1	
16.3	Drainpipe	12626000000008		1	
17	Fan clip	12225000000126		1	
18	Water level switch	17400511000039		1	
19	Drain pump	17400802001113		1	
20	Bracket of water level sensor	12126000000043		1	
21	Water Pump installation bracket ass'y	12226000000115		1	
22	Rubber washer	12600401001935		3	
23	Weak electric cable group	17401204009025		1	
24	Ground wire	17401108000193		1	
24	Ground wire	17401108000217		1	
25	Copper nut	15500406000010		1	
25	Copper nut	15500406000003		1	
26	Fan fence	12126000000041		1	
28	Support	12226000003733		1	
28	Beam boarding	12927000000051		3	

**The data are subject to change without notice.**



SDV5-140CA

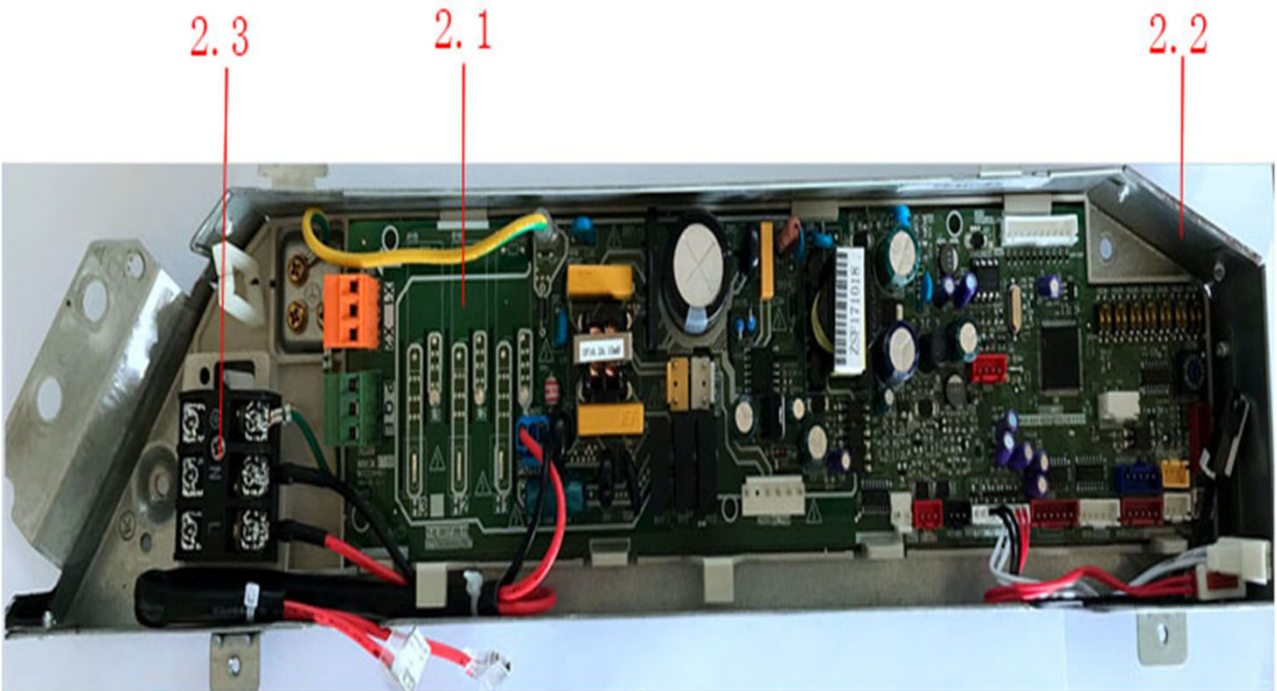
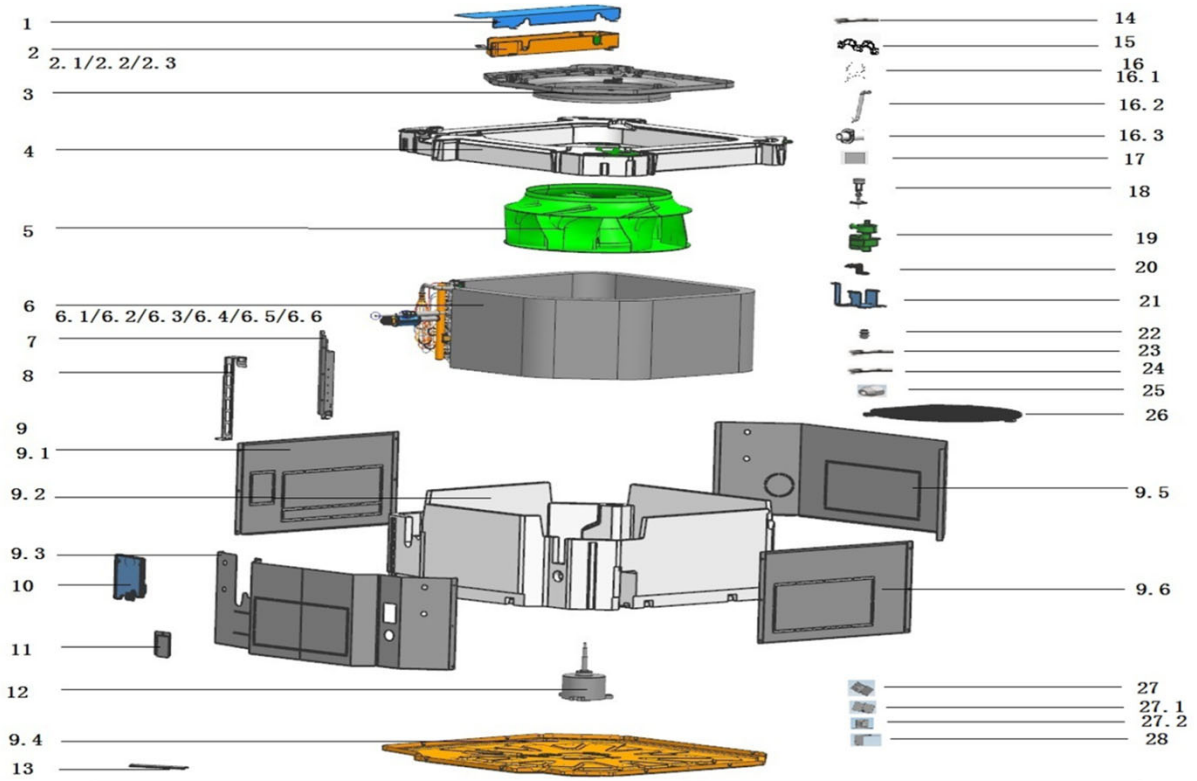

No	Description	Part Code	Note	Qty	Price Code
<b>MODEL: SDV5-140CA CASSETTE FOUR-WAY UNIT</b>					
1	E-part box cover ass'y	12226000000127		1	
2	E-part box assembly	17226000002638		1	
2.1	Indoor unit main control board	17126000003315		1	
2.2	E-part box ass'y	12226000000128		1	
2.3	Wire terminal	17400401000189		1	
3	Ring ass'y	12126000000114		1	
4	Foam parts water tray	12826000000007		1	
5	centrifuge fan	12100103000142		1	
6	Evaporator assembly	15826000002235		1	
6.1	Evaporator	15826000000218		1	
6.2	Evaporator input pipe ass'y	15426000000169		1	
6.3	Evaporator output pipe ass'y	15126000001325		1	
6.6	Pipe temperature sensor assemblies	11201007003024		1	
7	Evaporator connection board	12226000000120		1	
8	Evaporator fixing hanger	12226000000111		3	
9	Chassis assembly	12226000003753		1	
9.1	Board II ass'y	12226000000095		1	
9.2	Foam	12826000000014		1	
9.4	Bass ass'y	12226000000506		1	
9.5	Coaming assembly	12226000000106		1	
9.6	Board ass'y	12226000000090		1	
10	Sealed board ass'y	12126000000332		1	
11	Cover subassembly	12225000000067		1	
12	Brushless DC Motor	11002015002002		1	
13	Clip	12200203000041		1	
14	Room Temperature Sensor	11201007003044		1	
15	Clip	12200203000041		1	
16	drain pipe ass'y	12626000000010		1	
16.1	Spring	12225000000376		1	
16.2	Water pipe	12100509000068		1	
16.3	Drainpipe	12626000000008		1	
17	Fan clip	12225000000126		1	
18	Water level switch	17400511000039		1	
19	Drain pump	17400802001113		1	
20	Bracket of water level sensor	12126000000043		1	
21	Water Pump installation bracket ass'y	12226000000115		1	
22	Rubber washer	12600401001935		3	
23	Weak electric cable group	17401204009025		1	
24	Ground wire	17401108000193		1	
24	Ground wire	17401108000217		1	
25	Copper nut	15500406000003		1	
25	Copper nut	15500406000010		1	
26	Fan fence	12126000000041		1	
28	Support	12226000003733		1	

**The data are subject to change without notice.**

# NOTE CONCERNING PROTECTION OF ENVIRONMENT

---



This product must not be disposed of via normal household waste after its service life, but must be taken to a collection station for the recycling of electrical and electronic devices. The symbol on the product, the operating instructions or the packaging indicate such disposal procedures. The materials are recyclable in accordance with their respective symbols. By means of re-use, material recycling or any other form of recycling old appliances you are making an important contribution to the protection of our environment. Please ask your local council where your nearest disposal station is located.

## INFORMATION CONCERNING USED REFRIGERANT MEDIUM

---

This unit is containing fluorinated gases included in the Kyoto protocol. The maintenance and the liquidation must be carried out by qualified personnel.

Type of refrigerant: R410A

The composition of the cooling medium R410A: (50% HFC-32, 50% HFC-125)

The quantity of the refrigerant: please see the unit label.

The value GWP: 2088 (1 kg R410A = 2,088 t CO<sub>2</sub> eq)

GWP = Global Warming Potential

In case of quality problem or other please contact your local supplier or authorized service center.

**Emergency number: 112**

## PRODUCER

---

SINCLAIR CORPORATION Ltd.

1-4 Argyll St.

London W1F 7LD

Great Britain

[www.sinclair-world.com](http://www.sinclair-world.com)

This product was manufactured in China (Made in China).

## REPRESENTATIVE

---

SINCLAIR Global Group s.r.o.

Purkynova 45

612 00 Brno

Czech Republic

## TECHNICAL SUPPORT

---

SINCLAIR Global Group s.r.o.

Purkynova 45

612 00 Brno

Czech Republic

Tel.: +420 800 100 285

Fax: +420 541 590 124

[www.sinclair-solutions.com](http://www.sinclair-solutions.com)

[info@sinclair-solutions.com](mailto:info@sinclair-solutions.com)

