

SDV5-80CA

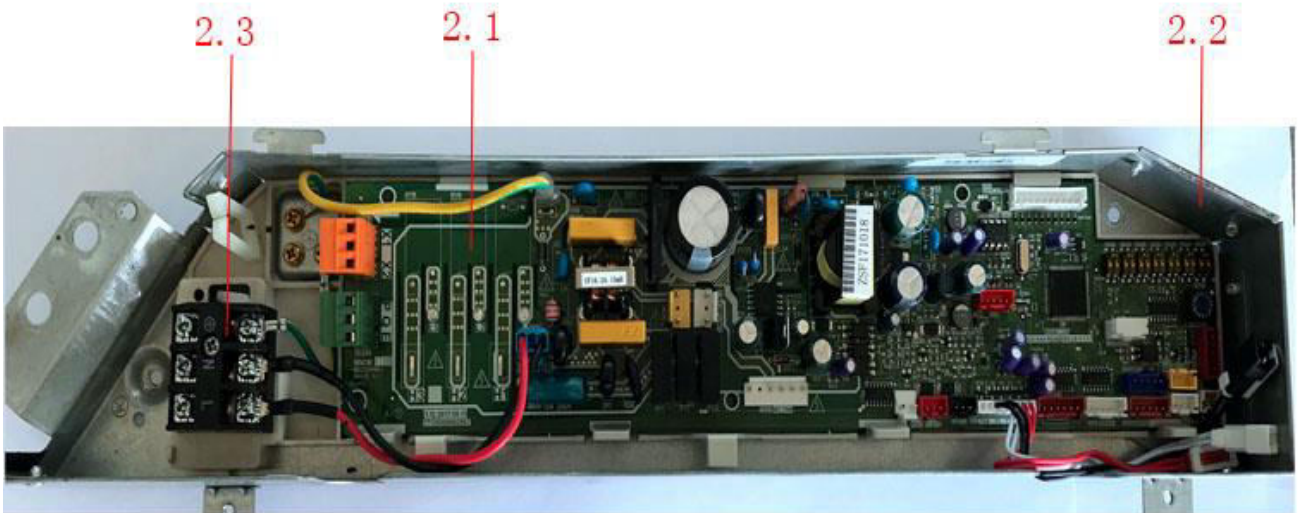
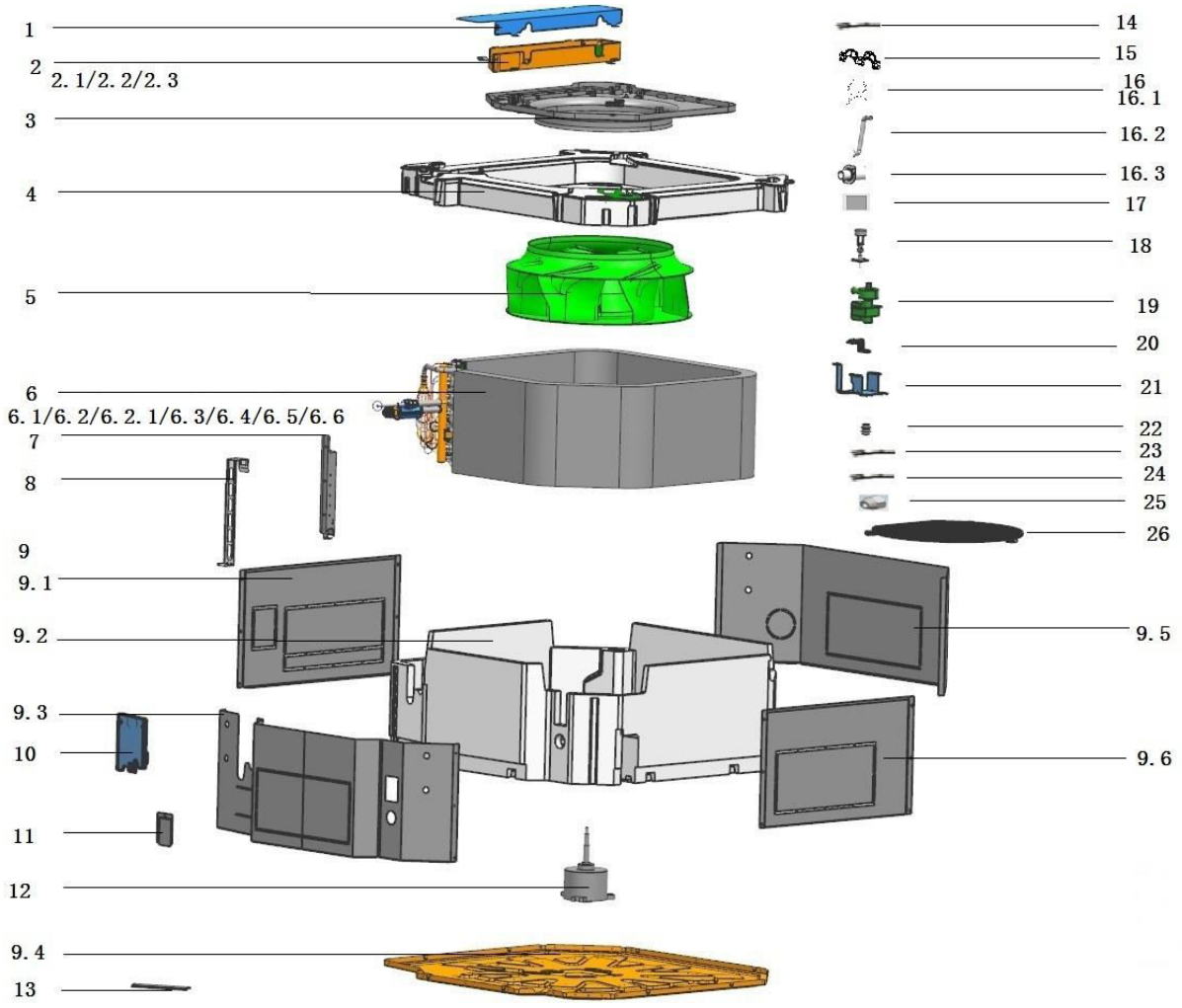

No	Description	Part Code	Note	Qty	Price Code
MODEL: SDV5-80CA CASSETTE FOUR-WAY UNIT					
1	E-part box cover ass'y	12226000000127		1	AL
2	E-part box assembly	17226000002639		1	BQ
2.1	Indoor unit main control board	17126000005140		1	BN
2.2	E-part box ass'y	12226000000128		1	AP
2.3	Wire terminal	17400401000189		1	AG
3	Ring ass'y	12126000000114		1	AU
4	Foam parts water tray	12826000000020		1	BN
5	centrifuge fan	12100103000149		1	BE
6	Evaporator assembly	15826000002236		1	BT
6.1	Evaporator	15826000000209		1	CB
6.2	Evaporator input pipe ass'y	15426000000171		1	BD
6.2.1	Electronic expansion valve suite	15500213000968		1	BA
6.3	Evaporator output pipe ass'y	15126000001334		1	AV
6.4	Pipe Temperature Sensor	11201007003023		1	AH
6.5	Pipe Temperature Sensor	11201007003024		1	AG
7	Evaporator connection board	12226000000118		1	AF
8	Evaporator fixing hanger	12226000000112		2	AD
9	Chassis assembly	12226000003754		1	BH
9.1	Board ass'y	12226000000091		1	AQ
9.2	Foam	12826000000018		1	BB
9.3	Board ass'y	12226000000094		1	AV
9.4	Base ass'y	12222500000952		1	BB
9.5	Board ass'y	12226000000093		1	AV
9.6	Board ass'y	12226000000092		1	AQ
10	Sealed board ass'y	12126000000332		1	AF
11	Cover subassembly	12222500000067		1	AC
12	Brushless DC Motor	11002015002001		1	BM
13	Clip	12200203000041		1	AC
14	Room Temperature Sensor	11201007003044		1	AG
16	drain pipe ass'y	12626000000011		1	AM
16.1	Spring	12222500000376		1	AC
16.2	Water pipe	12100509000068		1	AG
16.3	Drainpipe	12626000000009		1	AQ
17	Fan clip	12222500000126		1	AC
18	Water level switch	17400511000039		1	AN
19	Drain pump	17400802001113		1	AW
20	Bracket of water level sensor	12126000000043		1	AC
21	Water Pump installation bracket assembly	12226000000115		1	AF
22	Rubber washer	12600401001935		3	AC
23	Weak electric cable group	17401204009025		1	AK
24	Ground wire	17401108000193		1	AC
25	Brass nut	15500406000190		1	AG
25	Brass nut	15500406000210		1	AE
26	Fan fence	12126000000041		1	AM

The data are subject to change without notice.